



Special Rates when you book by April 30, 2024!

RIVER CRUISE FOR WINE LOVERS

Forrest Wines

Aboard AmaBella • 7 Nights • June 2 to 9, 2025

Giurgiu, Romania to Budapest, Hungary

Note: Stateroom layouts shown below are not to scale.



Suite, Violin Deck
French Balcony & Outside Balcony, 350 sq. ft.

Brochure Fare \$13,111NZD / \$7,898USD pp
Wine Cruise \$11,450NZD / \$6,898USD pp

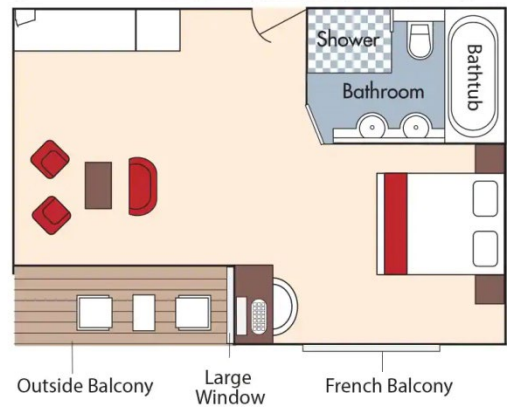

CAT. AA, Violin Deck
French Balcony & Outside Balcony, 235 sq. ft.

Brochure Fare \$10,953NZD / \$6,598USD pp
Wine Cruise \$9,292NZD / \$5,598USD pp



Fares listed are cruise-only, per person based on double occupancy and do not include port charges of \$383 NZD / \$231 USD per person. New Zealand prices are estimates only; all charges will be made in USD subject to the then-current exchange rate.



CAT. AB, Cello Deck
French Balcony & Outside Balcony, 235 sq. ft.

Brochure Fare ~~\$10,621~~NZD / ~~\$6,398~~USD pp
 Wine Cruise \$8,960NZD / \$5,398USD pp



CAT. BA, Violin Deck
French Balcony & Outside Balcony, 210 sq. ft.

Brochure Fare ~~\$10,289~~NZD / ~~\$6,198~~USD pp
 Wine Cruise \$8,628NZD / \$5,198USD pp

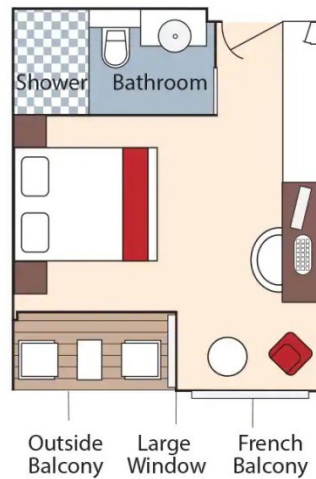

Fares listed are cruise-only, per person based on double occupancy and do not include port charges of \$383 NZD / \$231 USD per person. New Zealand prices are estimates only; all charges will be made in USD subject to the then-current exchange rate.



CAT. BB, Cello Deck
 French Balcony & Outside Balcony, 210 sq. ft.

Brochure Fare ~~\$9,957~~NZD / ~~\$5,998~~USD pp
 Wine Cruise \$8,296NZD / \$4,998USD pp

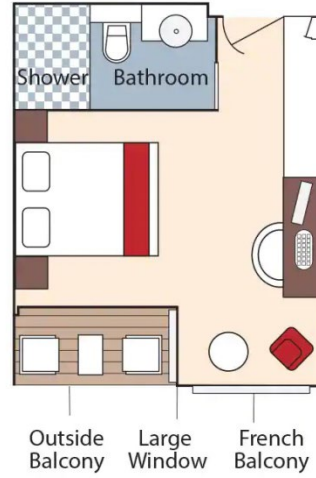

CAT. C, Violin & Cello Deck
 French Balcony, 170 sq. ft.

Brochure Fare ~~\$8,961~~NZD / ~~\$5,398~~USD pp
 Wine Cruise \$7,300NZD / \$4,398USD pp

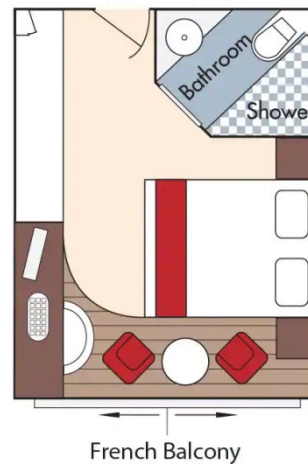

*Fares listed are cruise-only, per person based on double occupancy and do not include port charges of \$383 NZD / \$231 USD per person.
 New Zealand prices are estimates only; all charges will be made in USD subject to the then-current exchange rate.*



CAT. D, Piano Deck
Fixed Windows, 170 sq. ft.

Brochure Fare \$7,135NZD / \$4,298USD pp
Wine Cruise \$5,474NZD / \$3,298USD pp

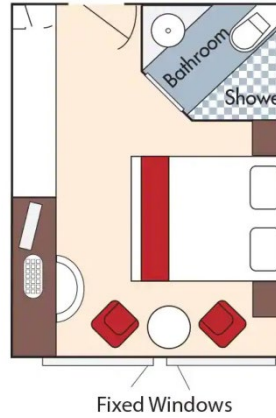

CAT. E, Piano Deck
Fixed Windows, 170 sq. ft.

Brochure Fare \$6,638NZD / \$3,999USD pp
Wine Cruise \$4,977NZD / \$2,999USD pp

AmaBella DECK PLAN

1	Lower Sun Deck
2	Navigation Bridge
3	Bicycles
4	Heated Pool
5	Sun Deck
6	Walking Track
7	Putting Green
8	Bow Seating Area
9	Observation Lounge
10	Main Lounge & Bar
11	Gift Shop
12	Reception
13	Massage & Hair Salon
14	Fitness Room
15	The Chef's Table Restaurant
16	Main Restaurant
17	Elevator
18	Crew Cabins

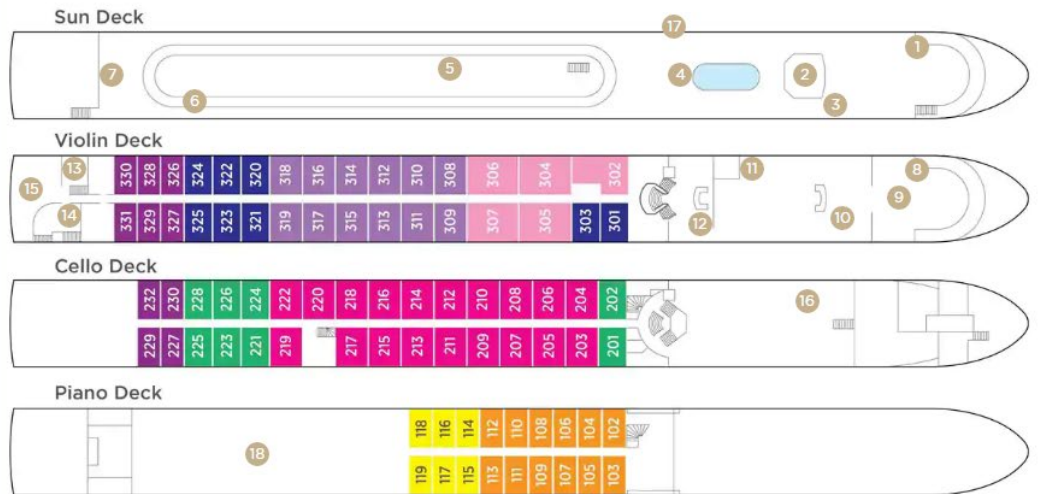

Stateroom Categories



Fares listed are cruise-only, per person based on double occupancy and do not include port charges of \$383 NZD / \$231 USD per person.
New Zealand prices are estimates only; all charges will be made in USD subject to the then-current exchange rate.