



**Special Rates when you book
by March 31, 2024!**

RIVER CRUISE FOR WINE LOVERS

Steven Kent Winery • April 4 – 11, 2024

Bordeaux • Libourne • Saint-Émilion • Blaye • Bourg • Pauillac • Cadillac

AmaDolce



Suite, Violin Deck
French Balcony, 255 sq. ft.

Note: Stateroom layouts shown below are not to scale.



Brochure Fare: ~~\$6,898 pp~~
YOUR RATE: \$6,648 pp



CAT. A+, Violin Deck
French Balcony, 225 sq. ft.

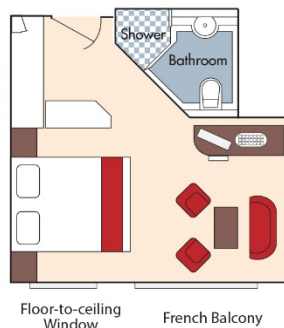

Brochure Fare: ~~\$6,598 pp~~
YOUR RATE: \$6,348 pp



CAT. A, Violin Deck
French Balcony, 170 sq. ft.

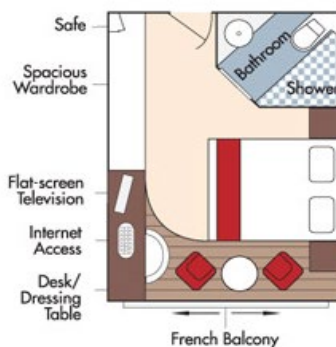

Brochure Fare: ~~\$5,598 pp~~
YOUR RATE: \$5,348 pp

CAT. B, Violin & Cello Deck
French Balcony, 170 sq. ft.

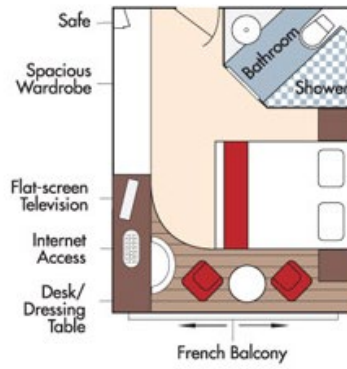

Brochure Fare: ~~\$5,498 pp~~
YOUR RATE: \$5,248 pp

CAT. C, Violin & Cello Deck
French Balcony, 170 sq. ft.

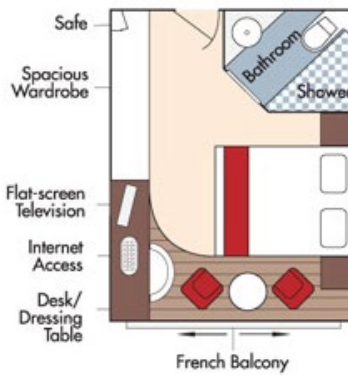
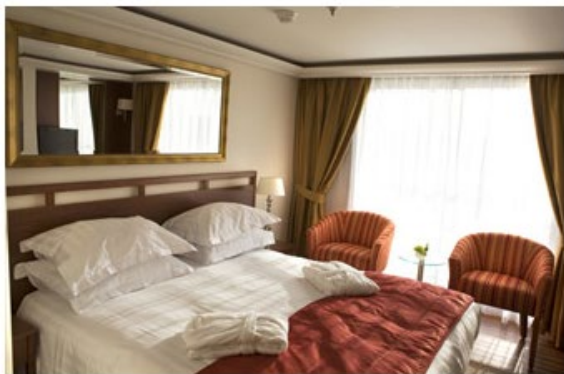

Brochure Fare: ~~\$5,198 pp~~
YOUR RATE: \$4,948 pp

CAT. E, Piano Deck
Fixed Windows, 170 sq. ft.

CAT. D, Piano Deck
Fixed Windows, 170 sq. ft.

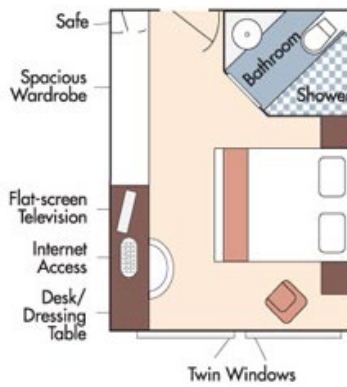

Category D
Brochure Fare: ~~\$4,198 pp~~
YOUR RATE: \$3,948 pp

Category E
Brochure Fare: ~~\$3,899 pp~~
YOUR RATE: \$3,649 pp

AmaDolce Deck Plan



Fares listed are cruise-only, per person based on double occupancy and do not include port charges of \$224 per person.