



Special Rates when you book by March 31, 2024

RIVER CRUISE FOR WINE LOVERS

Balletto Vineyards

Aboard AmaPrima • 7 Nights • April 10 to 17, 2024
Basel to Amsterdam

Note: Stateroom layouts shown below are not to scale.



Suite, Violin Deck
French Balcony & Outside Balcony, 300 sq. ft.

Brochure Fare \$7,198 pp
Your rate \$6,948 pp

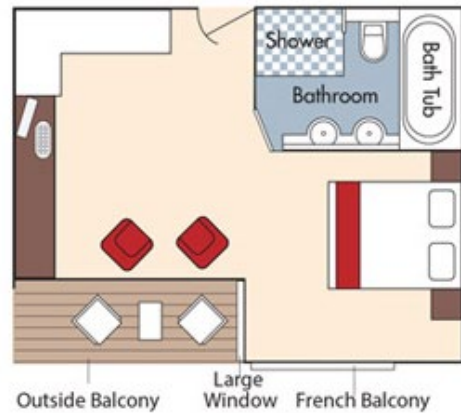

CAT. AA, Violin Deck
French Balcony & Outside Balcony, 235 sq. ft.

Brochure Fare \$5,898 pp
Your rate \$5,648 pp

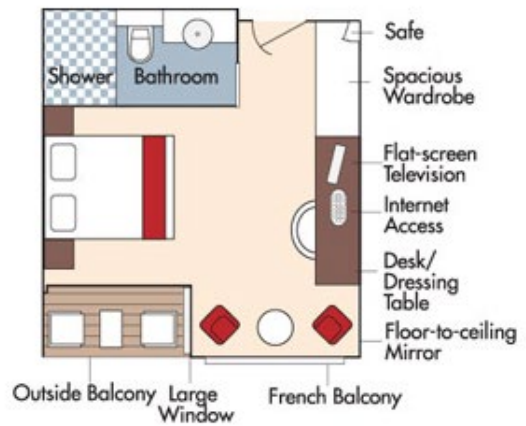

Fares listed are cruise-only, per person based on double occupancy and do not include port charges of \$224 per person.



CAT. AB, Cello Deck
French Balcony & Outside Balcony, 235 sq. ft.

Brochure Fare \$5,698 pp
 Your rate \$5,448 pp

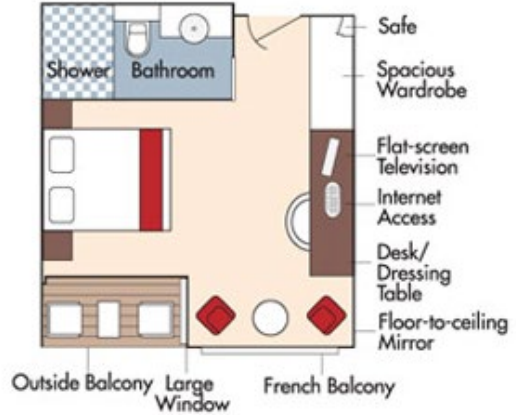

CAT. BA, Violin Deck
French Balcony & Outside Balcony, 210 sq. ft.

Brochure Fare \$5,498 pp
 Your rate \$5,248 pp

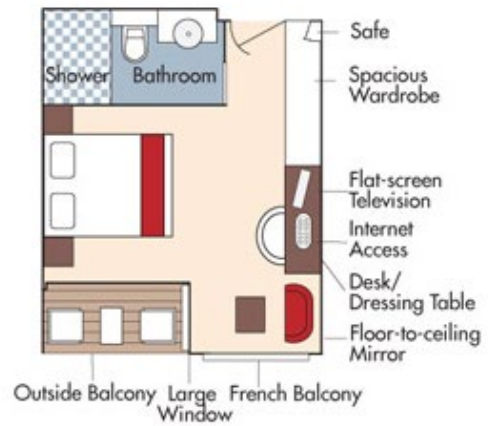



CAT. BB, Cello Deck
French Balcony & Outside Balcony, 210 sq. ft.

Brochure Fare ~~\$5,298~~ pp
 Your rate **\$5,048** pp

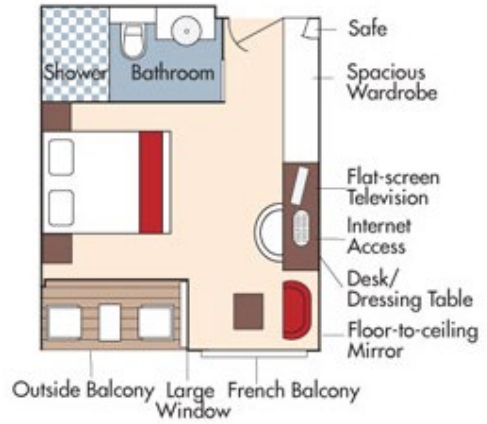

CAT. C, Violin & Cello Deck
French Balcony, 170 sq. ft.

Category C
 Brochure Fare ~~\$4,698~~ pp
 Your rate **\$4,448** pp

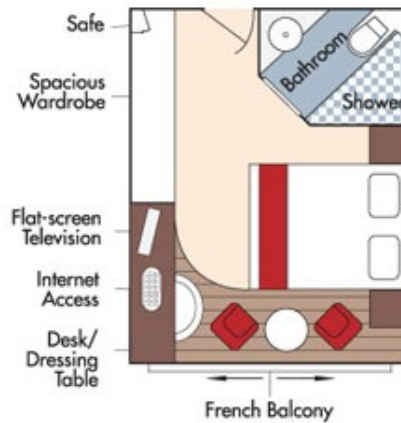



CAT. D, Piano Deck
Fixed Windows, 160 sq. ft.

Brochure Fare ~~\$3,698~~ pp
Your rate **\$3,448** pp

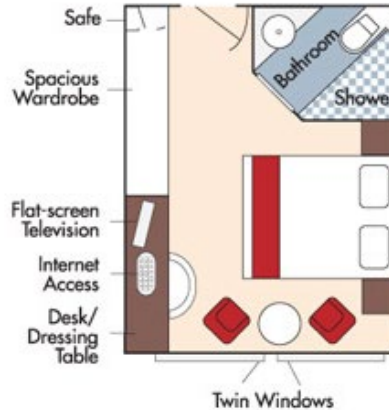

CAT. E, Piano Deck
Fixed Windows, 160 sq. ft.

Brochure Fare ~~\$3,399~~ pp
Your rate **\$3,149** pp

AmaPrima DECK PLAN

1	Lower Sun Deck
2	Navigation Bridge
3	Bicycles
4	Heated Pool
5	Sun Deck
6	Walking Track
7	Al Fresco Dining Terrace
8	Observation Lounge
9	Main Lounge & Bar
10	Gift Shop
11	Reception
12	Fitness Room
13	Massage & Hair Salon
14	The Chef's Table Restaurant
15	Main Restaurant
16	Elevator
17	Crew Cabins

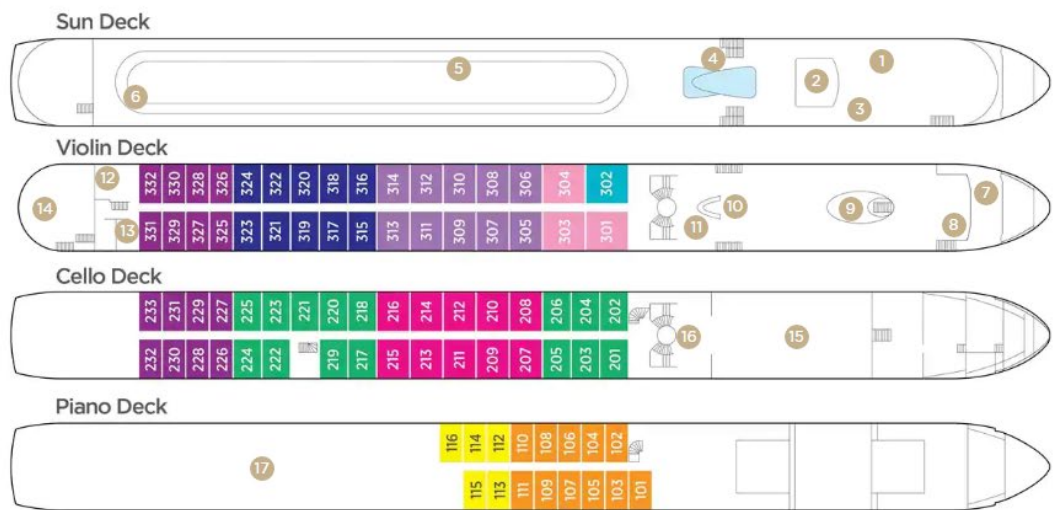

Note: Elevator reaches the Violin and Cello Deck (does not reach Piano Deck or Sun Deck).

Stateroom Categories

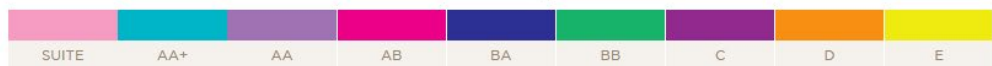

Fares listed are cruise-only, per person based on double occupancy and do not include port charges of \$224 per person.