



# RIVER CRUISE FOR WINE LOVERS

## American Wine Society

Aboard AmaDouro • 7 Nights • May 18 to 25, 2024

Porto • Entre-os-Rios • Régua • Pinhão • Vega Terrón • Salamanca • Barca d'Alva • Porto

Note: Stateroom layouts shown below are not to scale.

### Suite Porto Deck Balcony, 323 sq. ft.

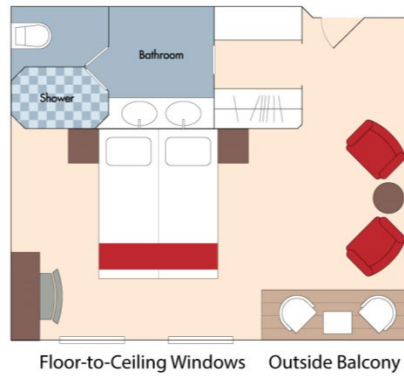

Wine Cruise Rate: \$8,198 pp

### Category A Porto Deck Balcony, 215 sq. ft.

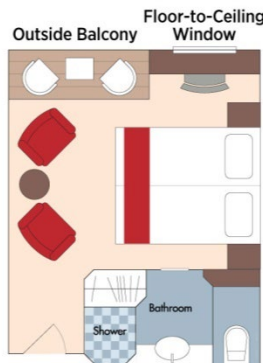

Wine Cruise Rate: \$6,498 pp

### Category B Lisbon Deck Balcony, 215 sq. ft.

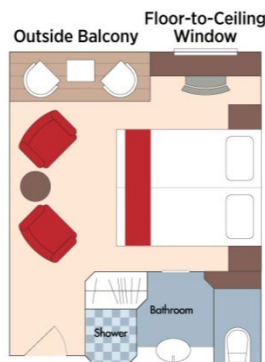

Wine Cruise Rate: \$6,198 pp

Fares listed are cruise-only, per person based on double occupancy and do not include port charges of \$224 per person.

**Category C *Porto Deck*** French Balcony, 161 sq. ft.

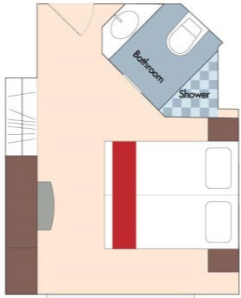

French Balcony

Wine Cruise Rate: \$5,598 pp

**Category D *Douro Deck*** Panoramic Window, 161 sq. ft.

**Category E *Douro Deck*** Panoramic Window, 161 sq. ft.

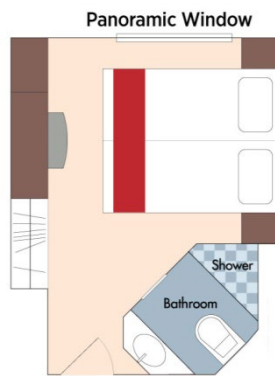

Category D  
Wine Cruise Rate: \$4,598 pp

Category E  
Wine Cruise Rate: \$4,299 pp

*AmaDouro*  
**DECK PLAN**

- 1 Main Lounge
- 2 Reception
- 3 Elevator
- 4 Main Restaurant
- 5 Fitness Room
- 6 Spa

**Sun Deck**

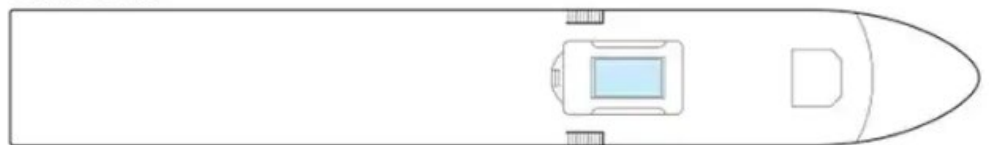

**Porto Deck**

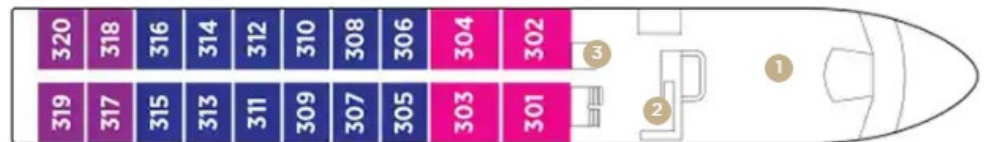

**Lisbon Deck**



**Douro Deck**



Stateroom Categories



Fares listed are cruise-only, per person based on double occupancy and do not include port charges of \$224 per person.