



Special Rates when you book  
by December 31, 2023!

# RIVER CRUISE FOR WINE LOVERS

## Sonoma-Cutrer Vineyards

Aboard AmaCello • 7 Nights • July 24-31, 2025

Port of Dijon • Seurre • Beaune • Chalon-Sur-Saône • Tournus • Brancion • Mâcon • Lyon

Note: Stateroom layouts shown below are not to scale.

Suite, Violin Deck  
French Balcony, 255 sq. ft.

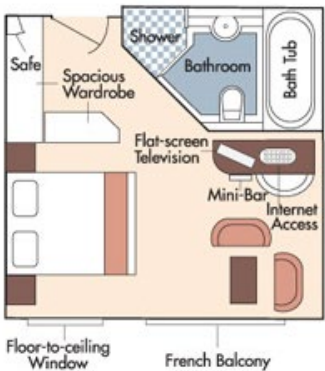

Brochure Fare: ~~\$7,698~~ pp  
Your Rate: ~~\$6,158~~<sup>40</sup> pp

CAT. A, Violin Deck  
French Balcony, 170 sq. ft.

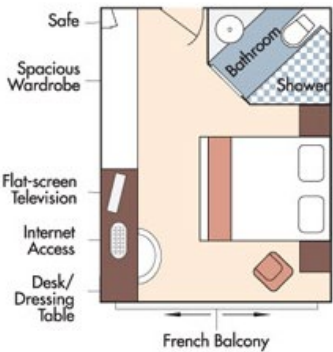

Brochure Fare: ~~\$6,398~~ pp  
Your Rate: ~~\$4,918~~<sup>40</sup> pp

CAT. B, Violin & Cello Deck  
French Balcony, 170 sq. ft.

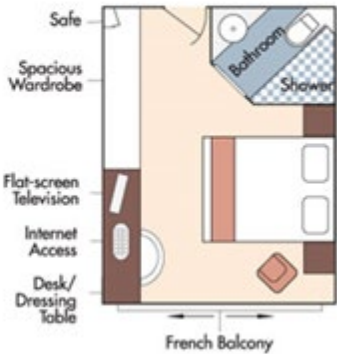

Brochure Fare: ~~\$6,298~~ pp  
Your Rate: ~~\$4,838~~<sup>40</sup> pp

Fares listed are cruise-only, per person based on double occupancy and do not include port charges of \$231 per person.

CAT. C, Violin & Cello Deck  
French Balcony, 170 sq. ft.

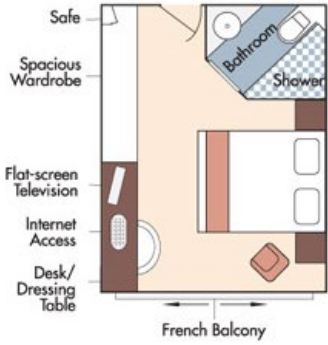

Brochure Fare: ~~\$5,998~~ pp  
Your Rate: ~~\$4,598~~<sup>40</sup> pp

CAT. E, Piano Deck  
Fixed Windows, 170 sq. ft.



CAT. D, Piano Deck  
Fixed Windows, 170 sq. ft.

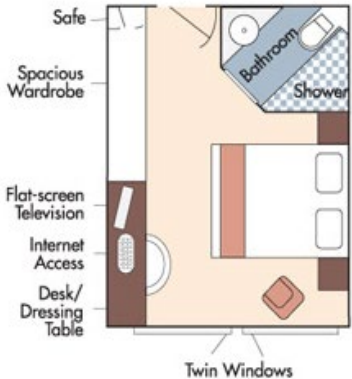

Category D  
Brochure Fare: ~~\$4,898~~ pp  
Your Rate: ~~\$3,718~~<sup>40</sup> pp

Category E  
Brochure Fare: ~~\$4,599~~ pp  
Your Rate: ~~\$3,479~~<sup>20</sup> pp

AmaCello  
DECK PLAN

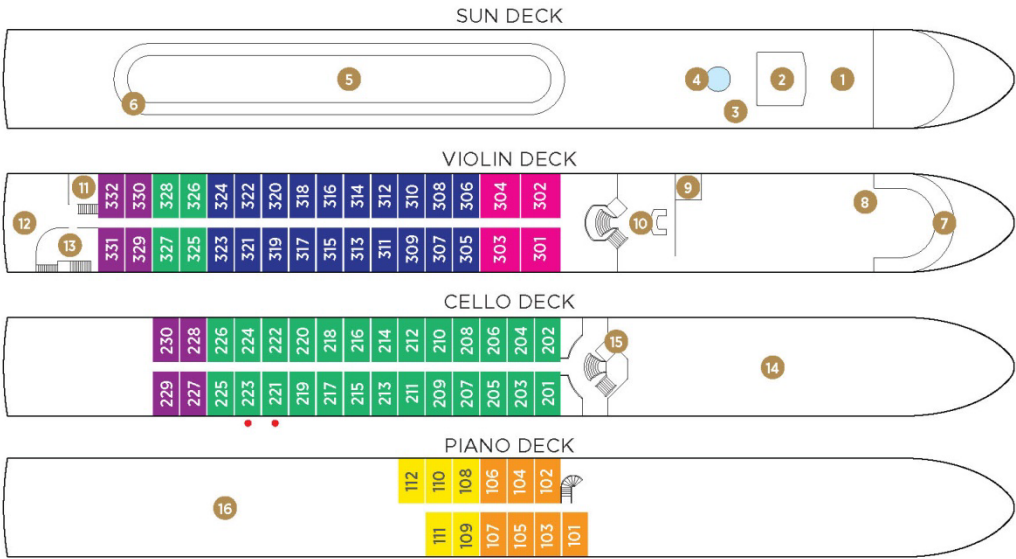

- 1 Observation Deck
- 2 Navigation Bridge
- 3 Bicycles
- 4 Whirlpool
- 5 Sun Deck
- 6 Walking Track
- 7 Bow Seating Area
- 8 Main Lounge & Bar
- 9 Gift Shop
- 10 Reception
- 11 Massage & Hair Salon
- 12 The Chef's Table Restaurant
- 13 Fitness Room
- 14 Main Restaurant
- 15 Elevator
- 16 Crew Cabins

Elevator reaches Main Restaurant, Lobby/Main Lounge and staterooms on Violin and Cello Deck.

Suite	Violin Deck / French Balcony - 255 sq. ft.	Cat. D	Piano Deck / Fixed Windows - 170 sq. ft.
Cat. A	Violin Deck / French Balcony - 170 sq. ft.	Cat. E	Piano Deck / Fixed Windows - 170 sq. ft.
Cat. B	Violin & Cello Deck / French Balcony - 170 sq. ft.	Single	Cello Deck / French Balcony - 140 sq. ft. (Single staterooms only available on AmaCello)
Cat. C	Violin & Cello Deck / French Balcony - 170 sq. ft.		

Fares listed are cruise-only, per person based on double occupancy and do not include port charges of \$231 per person.