



**Special Rates when you
book by December 31, 2023!**

RIVER CRUISE FOR WINE LOVERS

Forrest Wines

Aboard AmaBella • 7 Nights • June 2 to 9, 2025

Giurgiu, Romania to Budapest, Hungary

Note: Stateroom layouts shown below are not to scale.

Suite, Violin Deck
French Balcony & Outside Balcony, 350 sq. ft.

Brochure Fare ~~\$13,111~~NZD / ~~\$7,898~~USD pp
Wine Cruise **\$12,061NZD / \$7,266USD pp**

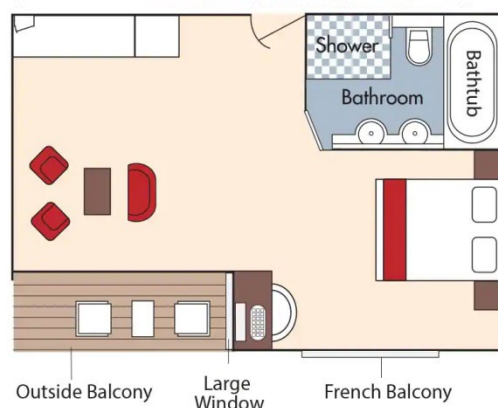

CAT. AA, Violin Deck
French Balcony & Outside Balcony, 235 sq. ft.

Brochure Fare ~~\$10,953~~NZD / ~~\$6,598~~USD pp
Wine Cruise **\$10,011NZD / \$6,031USD pp**



*Fares listed are cruise-only, per person based on double occupancy and do not include port charges of \$383 NZD / \$231 USD per person.
New Zealand prices are estimates only; all charges will be made in USD subject to the then-current exchange rate.*



CAT. AB, Cello Deck
French Balcony & Outside Balcony, 235 sq. ft.

Brochure Fare ~~\$10,621~~NZD / ~~\$6,398~~USD pp
Wine Cruise \$9,695NZD / \$5,841USD pp



CAT. BA, Violin Deck
French Balcony & Outside Balcony, 210 sq. ft.

Brochure Fare ~~\$10,289~~NZD / ~~\$6,198~~USD pp
Wine Cruise \$9,380NZD / \$5,651USD pp

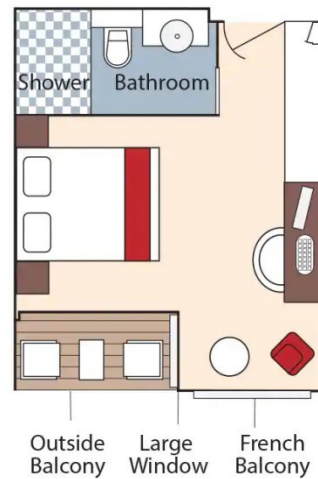

*Fares listed are cruise-only, per person based on double occupancy and do not include port charges of \$383 NZD / \$231 USD per person.
New Zealand prices are estimates only; all charges will be made in USD subject to the then-current exchange rate.*

CAT. BB, Cello Deck
French Balcony & Outside Balcony, 210 sq. ft.

Brochure Fare ~~\$9,957~~NZD / ~~\$5,998~~USD pp
 Wine Cruise \$9,065NZD / \$5,461USD pp

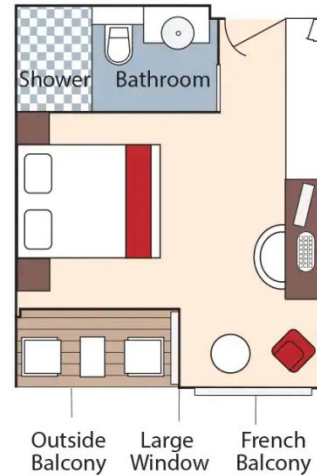

CAT. C, Violin & Cello Deck
French Balcony, 170 sq. ft.

Brochure Fare ~~\$8,961~~NZD / ~~\$5,398~~USD pp
 Wine Cruise \$8,118NZD / \$4,891USD pp

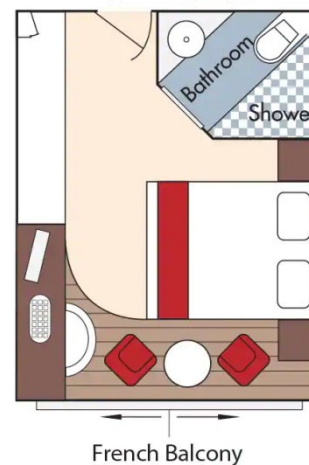

*Fares listed are cruise-only, per person based on double occupancy and do not include port charges of \$383 NZD / \$231 USD per person.
 New Zealand prices are estimates only; all charges will be made in USD subject to the then-current exchange rate.*



CAT. D, Piano Deck
Fixed Windows, 170 sq. ft.

Brochure Fare \$7,135NZD / \$4,298USD pp
Wine Cruise \$6,384NZD / \$3,846USD pp

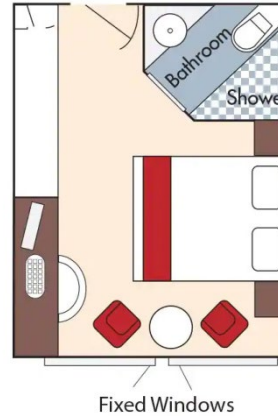

CAT. E, Piano Deck
Fixed Windows, 170 sq. ft.

Brochure Fare \$6,638NZD / \$3,999USD pp
Wine Cruise \$5,912NZD / \$3,562USD pp

AmaBella DECK PLAN

1	Lower Sun Deck
2	Navigation Bridge
3	Bicycles
4	Heated Pool
5	Sun Deck
6	Walking Track
7	Putting Green
8	Bow Seating Area
9	Observation Lounge
10	Main Lounge & Bar
11	Gift Shop
12	Reception
13	Massage & Hair Salon
14	Fitness Room
15	The Chef's Table Restaurant
16	Main Restaurant
17	Elevator
18	Crew Cabins

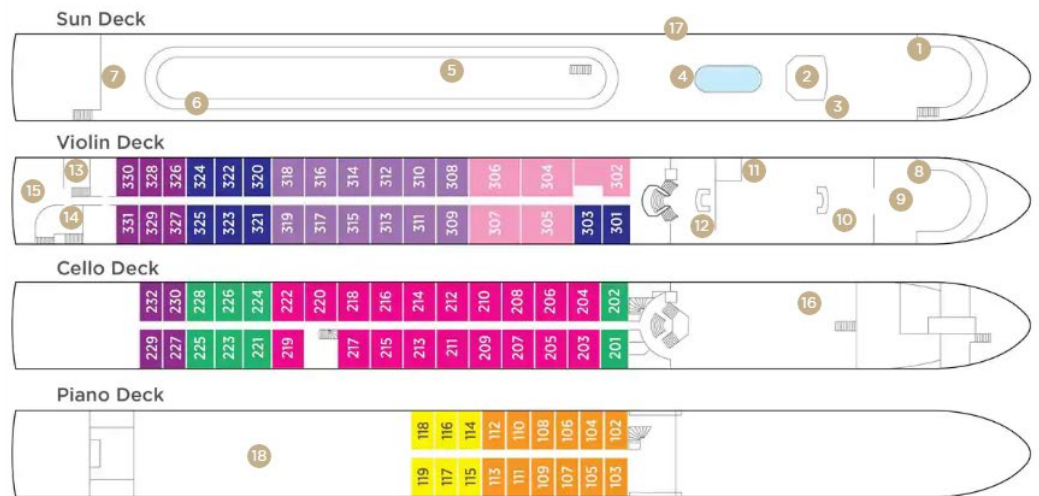

Stateroom Categories

SUITE	AA	AB	BA	BB	C	D	E
-------	----	----	----	----	---	---	---

Fares listed are cruise-only, per person based on double occupancy and do not include port charges of \$383 NZD / \$231 USD per person.
New Zealand prices are estimates only; all charges will be made in USD subject to the then-current exchange rate.