



**Special Rates when you  
book by June 30, 2023**

# The Rotary Foundation Cruise 2024

## Aboard AmaPrima • 7 Nights • August 14 - 21, 2024

### Amsterdam roundtrip

*Note: Stateroom layouts shown below are not to scale.*



**Suite, Violin Deck**  
**French Balcony & Outside Balcony, 300 sq. ft.**

Brochure Fare: ~~\$7,798~~ pp  
**Your rate: \$7,548 pp**

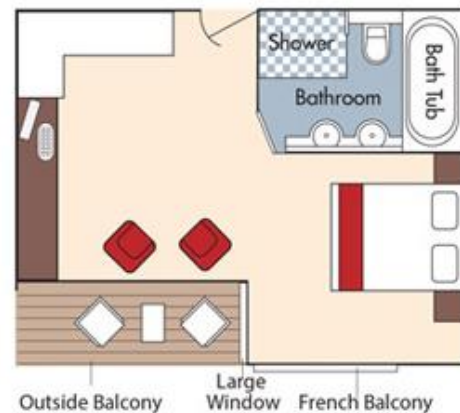

**CAT. AA, Violin Deck**  
**French Balcony & Outside Balcony, 235 sq. ft.**

Brochure Fare: ~~\$6,498~~ pp  
**Your rate: \$6,248 pp**

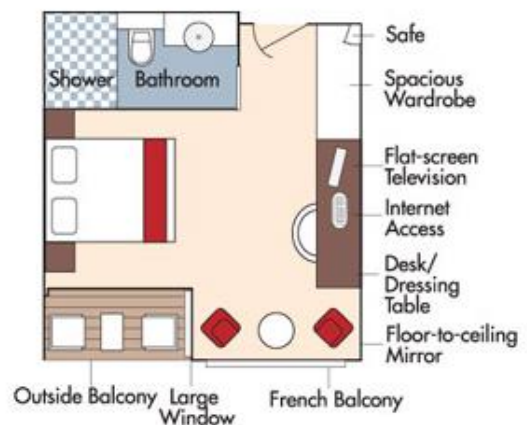



CAT. AB, Cello Deck  
French Balcony & Outside Balcony, 235 sq. ft.

Brochure Fare: ~~\$6,298~~ pp  
Your rate: **\$6,048 pp**

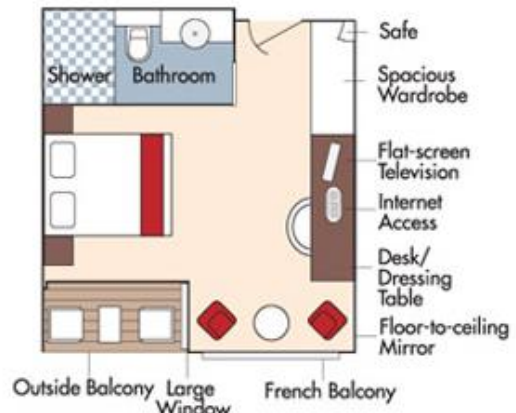

CAT. BA, Violin Deck  
French Balcony & Outside Balcony, 210 sq. ft.

Brochure Fare: ~~\$6,098~~ pp  
Your rate: **\$5,848 pp**

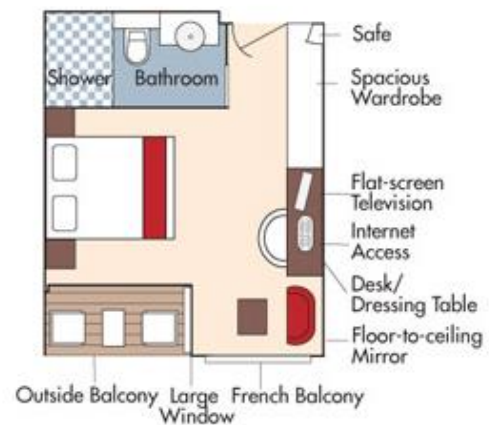

CAT. BB, Cello Deck  
French Balcony & Outside Balcony, 210 sq. ft.

Brochure Fare: ~~\$5,898~~ pp  
Your rate: **\$5,648 pp**

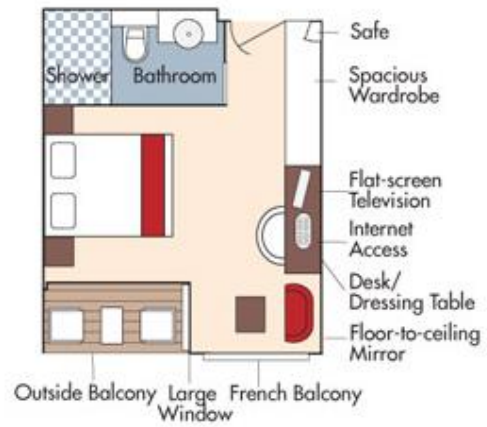

CAT. C, Violin & Cello Deck  
French Balcony, 170 sq. ft.

Category C  
Brochure Fare: ~~\$5,298~~ pp  
Your rate: **\$5,048 pp**

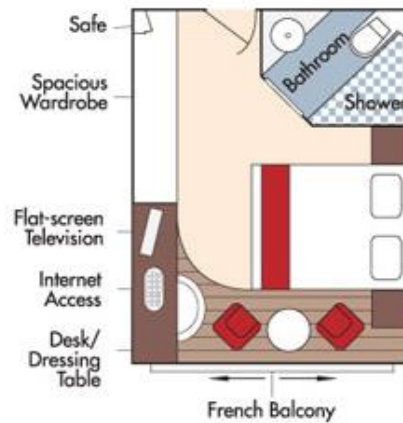



CAT. D, Piano Deck  
Fixed Windows, 160 sq. ft.



### Category D

Brochure Rate: ~~\$4,298 pp~~

Your Rate: **\$4,048 pp**

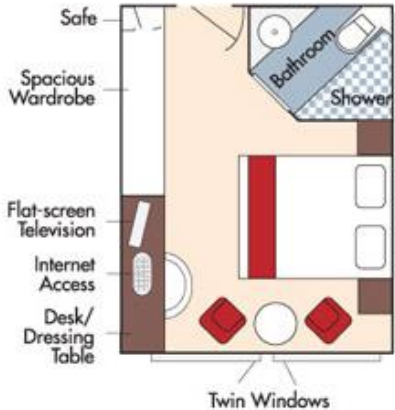

CAT. E, Piano Deck  
Fixed Windows, 160 sq. ft.

### Category E

Brochure Rate ~~\$3,999 pp~~

Your Rate **\$3,749 pp**

## AmaPrima DECK PLAN

|    |                             |
|----|-----------------------------|
| 1  | Lower Sun Deck              |
| 2  | Navigation Bridge           |
| 3  | Bicycles                    |
| 4  | Heated Pool                 |
| 5  | Sun Deck                    |
| 6  | Walking Track               |
| 7  | Al Fresco Dining Terrace    |
| 8  | Observation Lounge          |
| 9  | Main Lounge & Bar           |
| 10 | Gift Shop                   |
| 11 | Reception                   |
| 12 | Fitness Room                |
| 13 | Massage & Hair Salon        |
| 14 | The Chef's Table Restaurant |
| 15 | Main Restaurant             |
| 16 | Elevator                    |
| 17 | Crew Cabins                 |

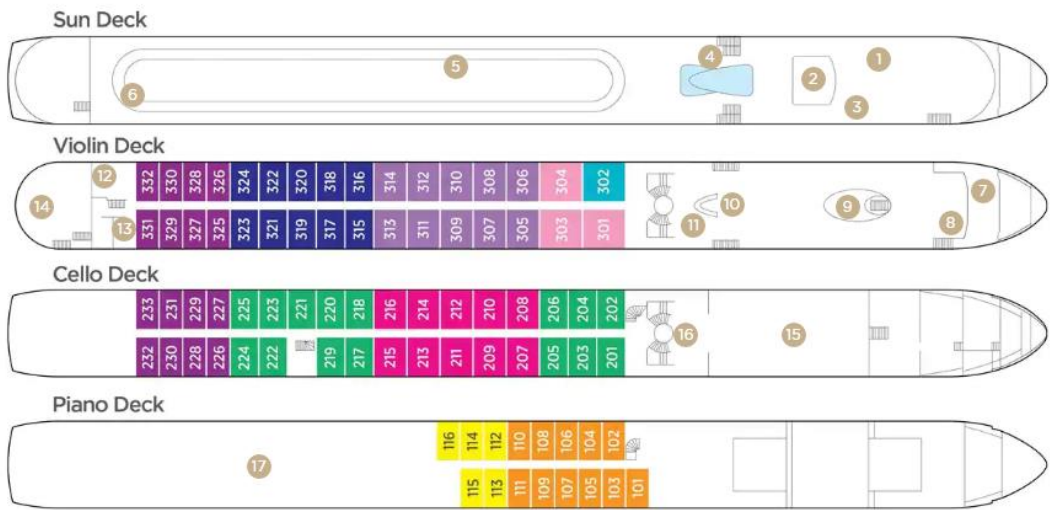

Note: Elevator reaches the Violin and Cello Deck (does not reach Piano Deck or Sun Deck).

#### Stateroom Categories

|       |     |    |    |    |    |   |   |   |
|-------|-----|----|----|----|----|---|---|---|
| SUITE | AA+ | AA | AB | BA | BB | C | D | E |
|-------|-----|----|----|----|----|---|---|---|

Fares listed are cruise-only, per person based on double occupancy and do not include port charges of \$224 per person.