

# WINE CRUISE FOR A CAUSE: HILINSKI'S HOPE

## WITH LOMBARDI WINES, VJB CELLARS, AND WELLINGTON CELLARS

Aboard AmaLyra • 7 Nights • July 4 to 11, 2024

Paris • Les Andelys • Le Havre • Caudebec-en-Caux • Rouen • Vernon • Paris

*Note: Stateroom layouts shown below are not to scale.*



Suite, Violin Deck  
French Balcony, 255 sq. ft.



Wine Cruise Rate: \$7,997 pp



CAT. A+, Violin Deck  
French Balcony, 225 sq. ft.



Wine Cruise Rate: \$7,697 pp

*Fares listed are cruise-only, per person based on double occupancy and do not include port charges of \$224 per person.*

**CAT. A, Violin Deck**  
French Balcony, 170 sq. ft.

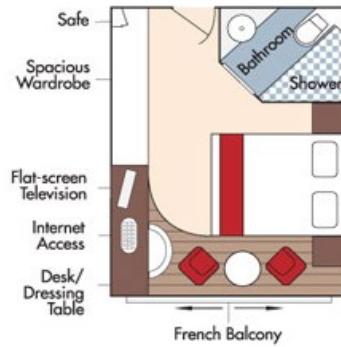

Wine Cruise Rate: \$6,697 pp

**CAT. B, Violin & Cello Deck**  
French Balcony, 170 sq. ft.

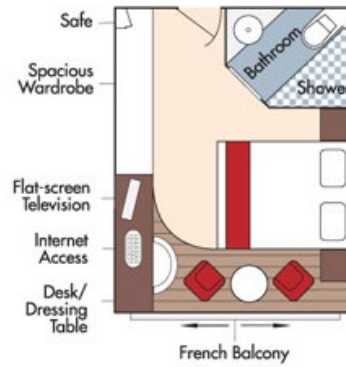

Wine Cruise Rate: \$6,597 pp

**CAT. C, Violin & Cello Deck**  
French Balcony, 170 sq. ft.

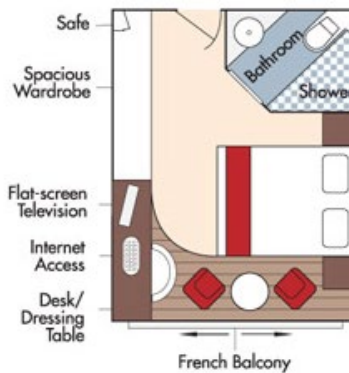

Wine Cruise Rate: \$6,297 pp



CAT. E, Piano Deck  
Fixed Windows, 170 sq. ft.



CAT. D, Piano Deck  
Fixed Windows, 170 sq. ft.

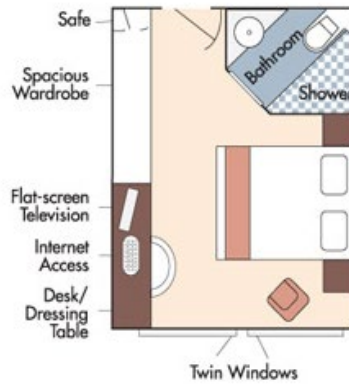

Category D  
Wine Cruise Rate: \$5,297 pp

Category E  
Wine Cruise Rate: \$4,998 pp

## AmaLyra DECK PLAN

1	Observation Deck
2	Navigation Bridge
3	Bicycles
4	Whirlpool
5	Sun Deck
6	Walking Track
7	Bow Seating Area
8	Main Lounge & Bar
9	Gift Shop
10	Reception
11	Massage & Hair Salon
12	The Chef's Table Restaurant
13	Fitness Room
14	Main Restaurant
15	Elevator
16	Crew Cabins

### Sun Deck



### Violin Deck



### Cello Deck



### Piano Deck



Note: Elevator reaches Main Restaurant, Lobby/Main Lounge and staterooms on Violin and Cello Deck (does not reach Piano Deck or Sun Deck).

### Stateroom Categories



Fares listed are cruise-only, per person based on double occupancy and do not include port charges of \$224 per person.