

CRUISE THROUGH THE VINEYARDS OF SOUTHERN FRANCE WITH FORTUNATI WINERY

7 Nights • June 6 to 13, 2024
Lyon to Arles – Aboard AmaKristina

Note: Stateroom layouts shown below are not to scale.



Suite *Violin Deck*

French Balcony & Outside Balcony, 350 sq. ft. **Wine cruise rate \$8,298 pp**

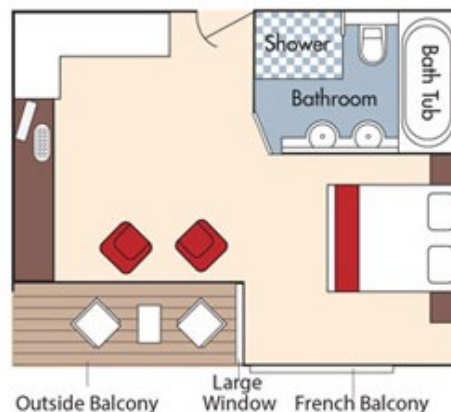

Category AA *Violin Deck*

French Balcony & Outside Balcony, 235 sq. ft. **Wine cruise rate \$6,998 pp**

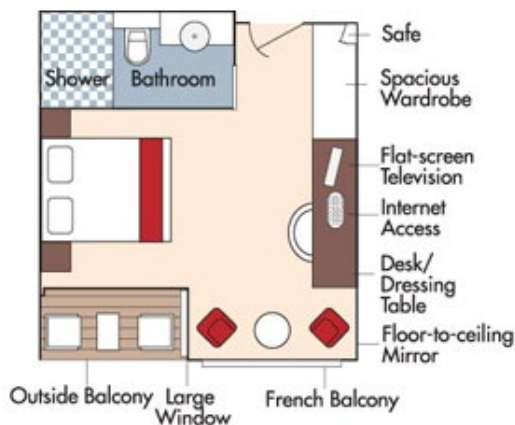

Fares listed are cruise-only, per person based on double occupancy and include the exclusive wine package. Port charges of \$224 per person are additional.



Category AB *Cello Deck*

French Balcony & Outside Balcony, 235 sq. ft. **Wine cruise rate \$6,798 pp**

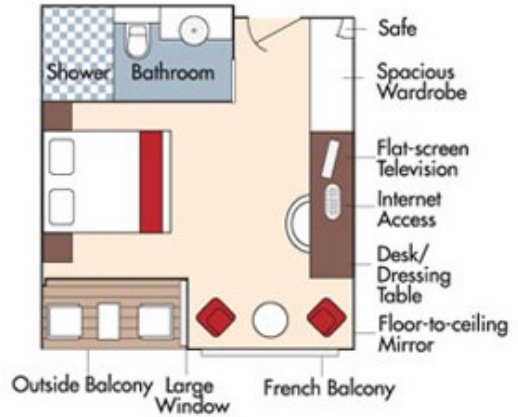

Category BA *Violin Deck*

French Balcony & Outside Balcony, 210 sq. ft. **Wine cruise rate \$6,598 pp**

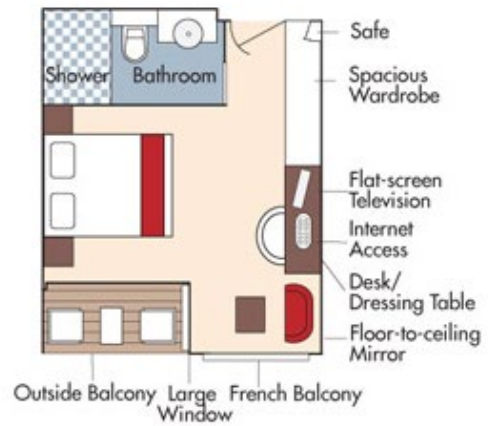



CAT. BB, Cello Deck

Category BB *Cello Deck*

French Balcony & Outside Balcony, 210 sq. ft.

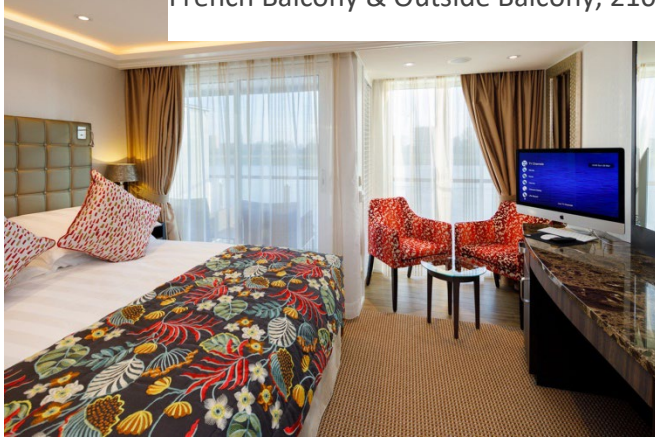

Wine cruise rate \$6,398 pp

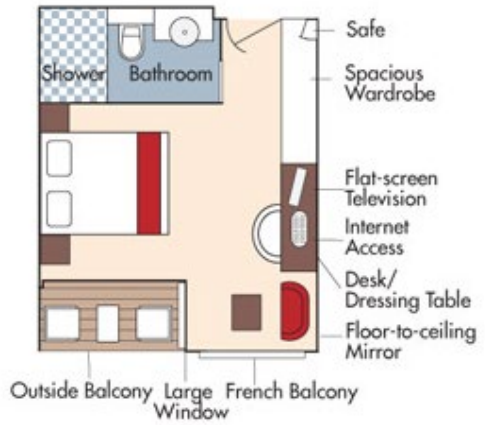

Category CA *Violin & Cello Deck*

French Balcony, 170 sq. ft.



Category CA

Wine cruise rate \$5,798 pp

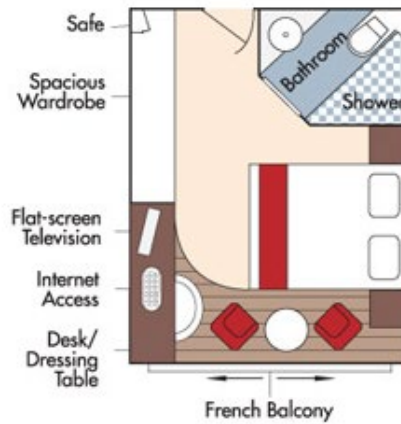

Category CB *Violin Deck*

French Balcony, 155 sq. ft.



Category CB

Wine cruise rate \$5,398 pp

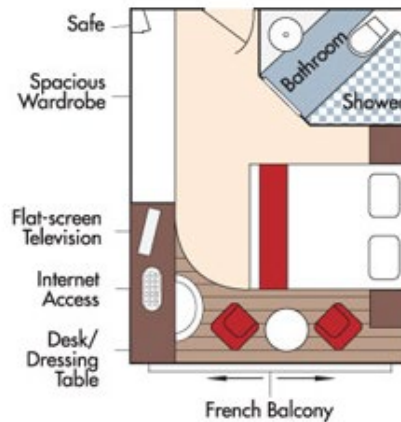

Fares listed are cruise-only, per person based on double occupancy and include the exclusive wine package. Port charges of \$224 per person are additional.

Category D *Piano Deck*
Fixed Windows, 160 sq. ft.



Wine cruise rate \$4,798 pp

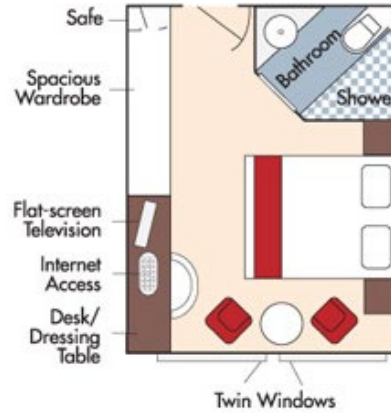

Category E *Piano Deck*
Fixed Windows, 160 sq. ft.

Wine cruise rate \$4,499 pp

AmaKristina
DECK PLAN

- 1 Lower Sun Deck
- 2 Navigation Bridge
- 3 Bicycles
- 4 Heated Pool
- 5 Sun Deck
- 6 Walking Track
- 7 Al Fresco Terrace
- 8 Observation Lounge
- 9 Main Lounge & Bar
- 10 Gift Shop
- 11 Reception
- 12 The Chef's Table Restaurant
- 13 Main Restaurant
- 14 Elevator
- 15 Massage & Hair Salon
- 16 Fitness Room
- 17 Crew Cabins

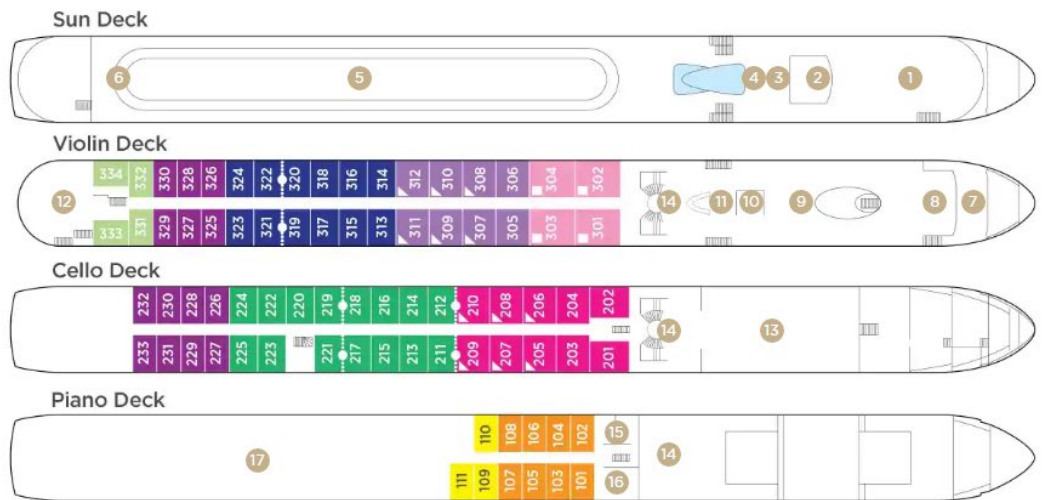

Note: Elevator reaches the Violin, Cello and Piano Deck (does not reach the Sun Deck).

Staterooms can become adjoining by request.

Up to triple occupancy

Stateroom Categories



Fares listed are cruise-only, per person based on double occupancy and include the exclusive wine package. Port charges of \$224 per person are additional.