

# Grand France Wine Cruise

## 21-Night Segment



Suite, Violin Deck  
French Balcony, 255 sq. ft.

Note: Stateroom layouts shown below are not to scale.

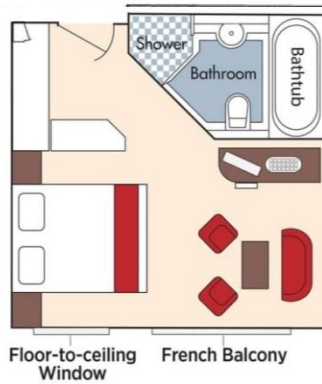

Wine Cruise Fare: \$23,394 pp



CAT. A+, Violin Deck  
French Balcony, 225 sq. ft.

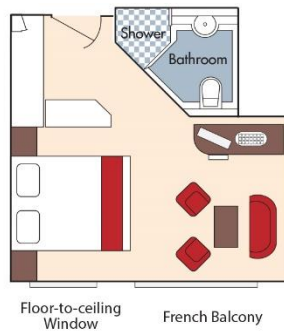

Wine Cruise Fare: \$22,944 pp



CAT. A, Violin Deck  
French Balcony, 170 sq. ft.

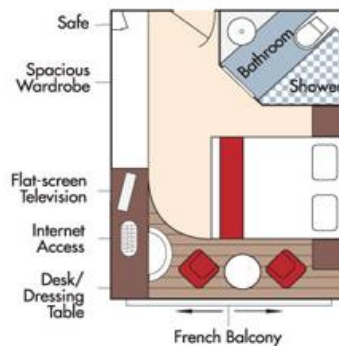

Wine Cruise Fare: \$19,494 pp

Fares listed are cruise-only, per person based on double occupancy and do not include port charges of \$630 per person. Stateroom photos above show typical décor for each stateroom category; actual décor may vary between ships.

CAT. B, Violin & Cello Deck  
French Balcony, 170 sq. ft.

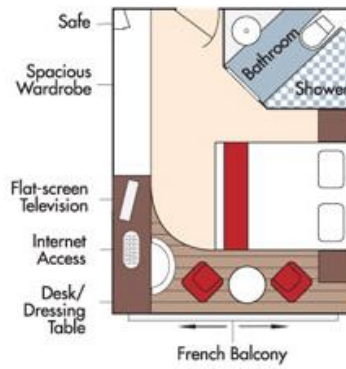

Wine Cruise Fare: \$19,194 pp

CAT. C, Violin & Cello Deck  
French Balcony, 170 sq. ft.

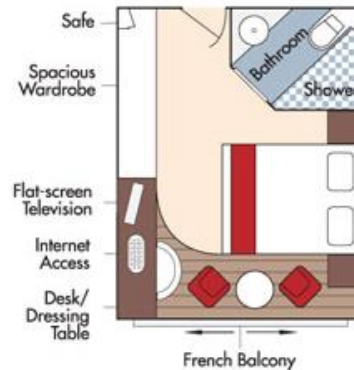

Wine Cruise Fare: \$18,294 pp

CAT. E, Piano Deck  
Fixed Windows, 170 sq. ft.



CAT. D, Piano Deck  
Fixed Windows, 170 sq. ft.

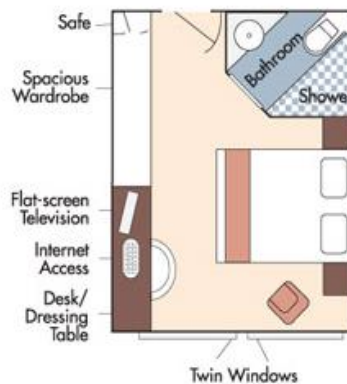

Category D

Wine Cruise Fare: \$15,144 pp

Category E

Wine Cruise Fare: \$14,247 pp

## Typical Deck Plan: AmaDolce, AmaLyra, AmaCello



Stateroom Categories



Fares listed are cruise-only, per person based on double occupancy and do not include port charges of \$630 per person. Stateroom photos above show typical décor for each stateroom category; actual décor may vary between ships.