

EXCLUSIVE 7-DAY PARIS TO NORMANDY WINE CRUISE!

AMALYRA APRIL 27-MAY 4, 2023

As a segment of the Grand France Wine Cruise, space is limited for individual segments.



Suite, Violin Deck
French Balcony, 255 sq. ft.

Note: Stateroom layouts shown below are not to scale.

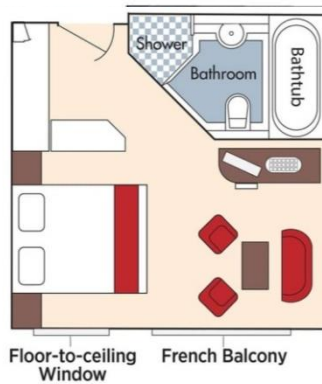

Brochure Fare: \$7,798 pp



CAT. A+, Violin Deck
French Balcony, 225 sq. ft.

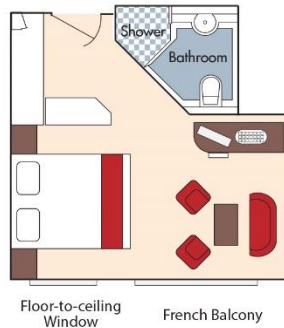

Brochure Fare: \$7,648 pp



CAT. A, Violin Deck
French Balcony, 170 sq. ft.

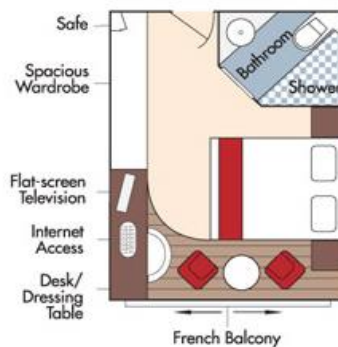

Brochure Fare: \$6,498 pp

Fares listed are cruise-only, per person based on double occupancy and do not include port charges of \$210 per person. Stateroom photos above show typical décor for each stateroom category; actual décor may vary.

CAT. B, Violin & Cello Deck
French Balcony, 170 sq. ft.

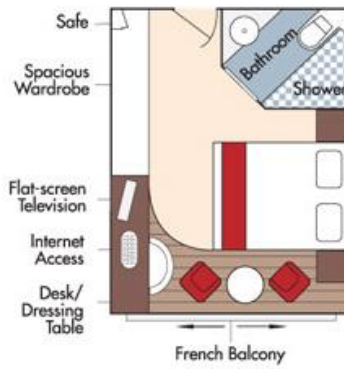

Brochure Fare: \$6,398 pp

CAT. C, Violin & Cello Deck
French Balcony, 170 sq. ft.

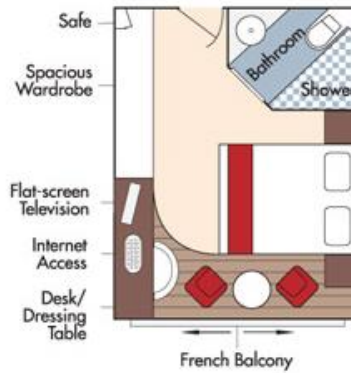

Brochure Fare: \$6,098 pp

CAT. E, Piano Deck
Fixed Windows, 170 sq. ft.



CAT. D, Piano Deck
Fixed Windows, 170 sq. ft.

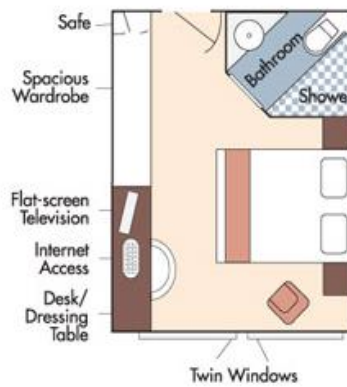

Category D
Brochure Fare: \$5,048 pp

Category E
Brochure Fare: \$4,749 pp

AmaLyra Deck Plan

Sun Deck

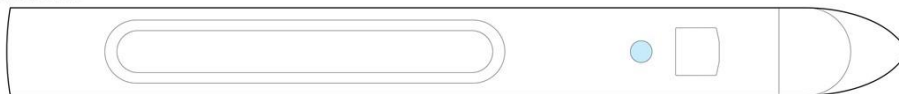

Violin Deck



Cello Deck



Piano Deck



Stateroom Categories



Fares listed are cruise-only, per person based on double occupancy and do not include port charges of \$210 per person. Stateroom photos above show typical décor for each stateroom category; actual décor may vary.