

Exclusive 7-Day Bordeaux Wine Cruise!

AmaDolce April 20-27, 2023

As a segment of the Grand France Wine Cruise, space is limited for individual segments.

Suite, Violin Deck
French Balcony, 255 sq. ft.

Note: Stateroom layouts shown below are not to scale.

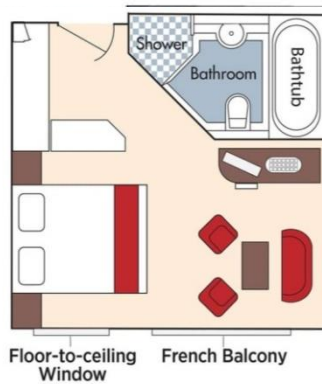

Wine Cruise Fare: \$7,798 pp

CAT. A+, Violin Deck
French Balcony, 225 sq. ft.

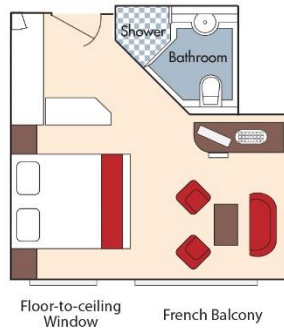

Wine Cruise Fare: \$7,648 pp

CAT. A, Violin Deck
French Balcony, 170 sq. ft.

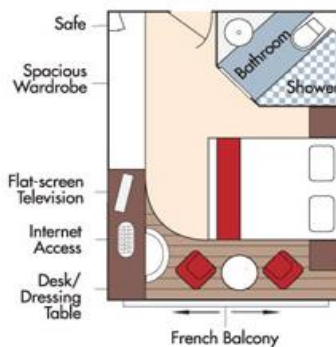

Wine Cruise Fare: \$6,498 pp

Fares listed are cruise-only, per person based on double occupancy and do not include port charges of \$210 per person. Stateroom photos above show typical décor for each stateroom category; actual décor may vary.

CAT. B, Violin & Cello Deck
French Balcony, 170 sq. ft.

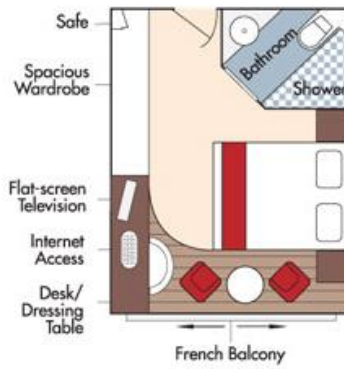

Wine Cruise Fare: \$6,398 pp

CAT. C, Violin & Cello Deck
French Balcony, 170 sq. ft.

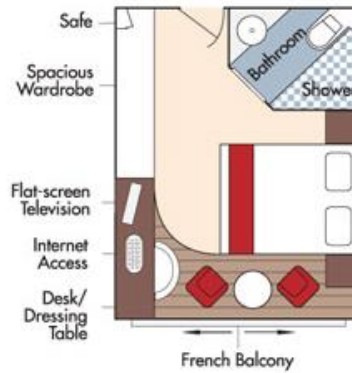

Wine Cruise Fare: \$6,098 pp

CAT. E, Piano Deck
Fixed Windows, 170 sq. ft.



CAT. D, Piano Deck
Fixed Windows, 170 sq. ft.

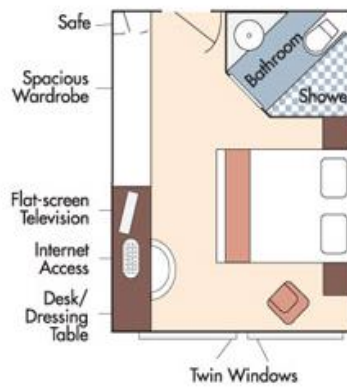

Category D
Wine Cruise Fare: \$5,048 pp

Category E
Wine Cruise Fare: \$4,749 pp

AmaDolce Deck Plan

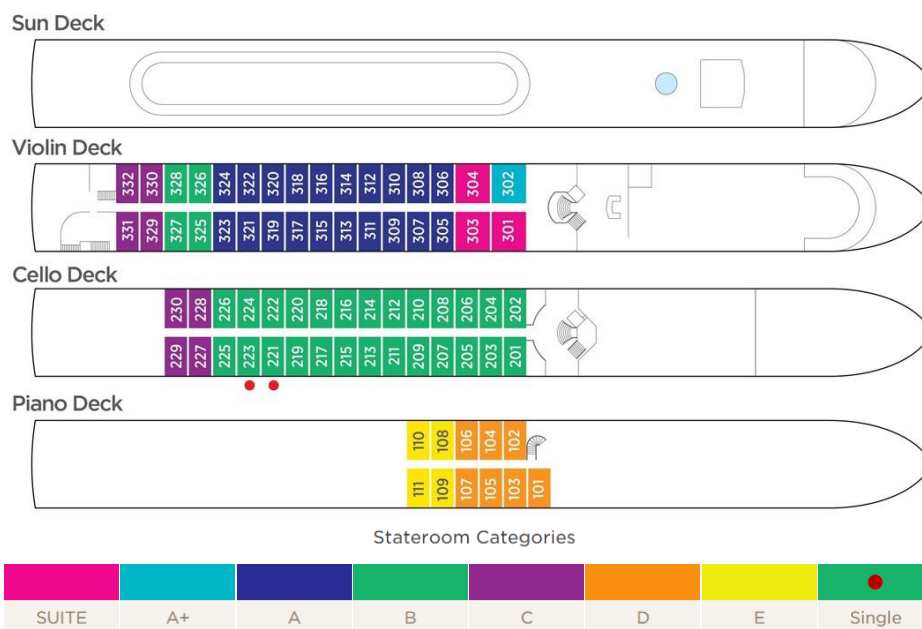

Fares listed are cruise-only, per person based on double occupancy and do not include port charges of \$210 per person. Stateroom photos above show typical décor for each stateroom category; actual décor may vary.