

# DISCOVER THE GEMS OF SOUTHEAST EUROPE WITH MONTEMAR WINERY!

ABOARD AMAMAGNA • 7 NIGHTS • MAY 7 TO 14, 2023  
Giurgiu, Romania to Budapest, Hungary

*Note: Stateroom layouts shown below are not to scale.*

## Category OS *Upper Deck*

Outside Balcony, 710 sq. ft.



## Wine Cruise Rate \$14,098 per person



- In-room temperature control
- Spacious bathrooms with multi-jet showerheads
- Large wardrobe, full-length mirror, hair dryer, safe and direct-dial telephone
- Flat-screen TV that also works as a computer
- Entertainment on Demand system providing complimentary TV, movies and music library
- Complimentary bottled water replenished daily
- Complimentary internet and Wi-Fi
- Desk and chair

Outside Balcony

## Category GS *Upper Deck*

Outside Balcony, 474 sq. ft.



## Wine Cruise Rate \$11,098 per person

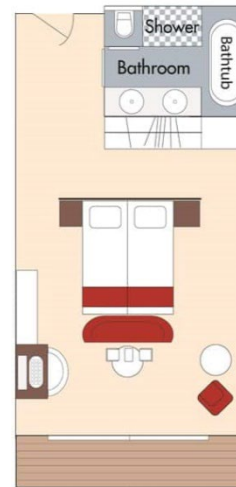

- In-room temperature control
- Spacious bathrooms with multi-jet showerheads
- Large wardrobe, full-length mirror, hair dryer, safe and direct-dial telephone
- Flat-screen TV that also works as a computer
- Entertainment on Demand system providing complimentary TV, movies and music library
- Complimentary bottled water replenished daily
- Complimentary internet and Wi-Fi
- Desk and chair

Outside Balcony

## Category SA *Upper Deck*

Outside Balcony, 355 sq. ft.



**Wine Cruise Rate \$7,398 per person**

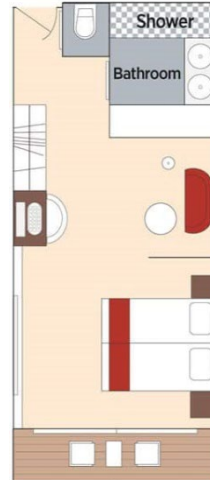

Outside Balcony

- In-room temperature control
- Spacious bathrooms with multi-jet showerheads
- Large wardrobe, full-length mirror, hair dryer, safe and direct-dial telephone
- Flat-screen TV that also works as a computer
- Entertainment on Demand system providing complimentary TV, movies and music library
- Complimentary bottled water replenished daily
- Complimentary internet and Wi-Fi
- Desk and chair

## Category SB *Main Deck*

Outside Balcony, 355 sq. ft.



**Wine Cruise Rate \$6,798 per person**

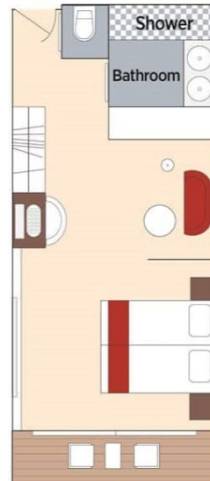

Outside Balcony

- In-room temperature control
- Spacious bathrooms with multi-jet showerheads
- Large wardrobe, full-length mirror, hair dryer, safe and direct-dial telephone
- Flat-screen TV that also works as a computer
- Entertainment on Demand system providing complimentary TV, movies and music library
- Complimentary bottled water replenished daily
- Complimentary internet and Wi-Fi
- Desk and chair

## Category AA *Upper Deck*

Outside Balcony, 252 sq. ft.



**Wine Cruise Rate \$6,398 per person**

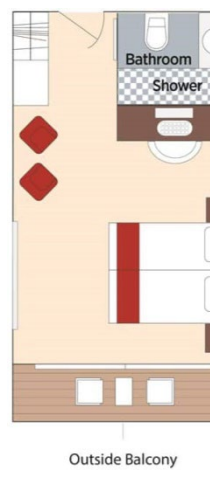

Outside Balcony

- In-room temperature control
- Spacious bathrooms with multi-jet showerheads
- Large wardrobe, full-length mirror, hair dryer, safe and direct-dial telephone
- Flat-screen TV that also works as a computer
- Entertainment on Demand system providing complimentary TV, movies and music library
- Complimentary bottled water replenished daily
- Complimentary internet and Wi-Fi
- Desk and chair

## Category AB *Main Deck*

Outside Balcony, 252 sq. ft.



**Wine Cruise Rate \$6,198 per person**

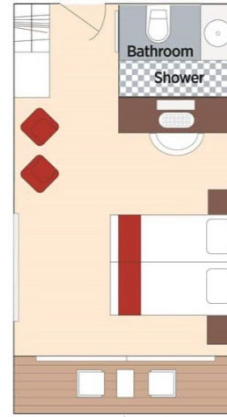

Outside Balcony

- In-room temperature control
- Spacious bathrooms with multi-jet showerheads
- Large wardrobe, full-length mirror, hair dryer, safe and direct-dial telephone
- Flat-screen TV that also works as a computer
- Entertainment on Demand system providing complimentary TV, movies and music library
- Complimentary bottled water replenished daily
- Complimentary internet and Wi-Fi
- Desk and chair

## Category D *Lower Deck*

Fixed Window, 205 sq. ft.



**Wine Cruise Rate \$4,698 per person**

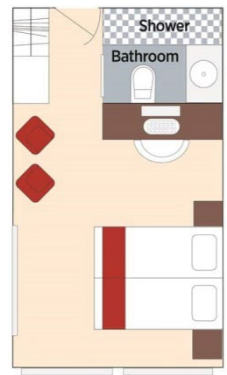

Fixed Windows

- In-room temperature control
- Spacious bathrooms with multi-jet showerheads
- Large wardrobe, full-length mirror, hair dryer, safe and direct-dial telephone
- Flat-screen TV that also works as a computer
- Entertainment on Demand system providing complimentary TV, movies and music library
- Complimentary bottled water replenished daily
- Complimentary internet and Wi-Fi
- Desk and chair

## Category E *Lower Deck*

Fixed Window, 205 sq. ft.



**Wine Cruise Rate \$4,099 per person**

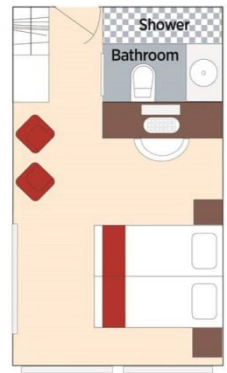

Fixed Windows

- In-room temperature control
- Spacious bathrooms with multi-jet showerheads
- Large wardrobe, full-length mirror, hair dryer, safe and direct-dial telephone
- Flat-screen TV that also works as a computer
- Entertainment on Demand system providing complimentary TV, movies and music library
- Complimentary bottled water replenished daily
- Complimentary internet and Wi-Fi
- Desk and chair

# AmaMagna DECK PLAN

- 1 Pop-Up Sky Bar
- 2 Pool / Whirlpool
- 3 Walking Track
- 4 The *Al Fresco* Restaurant
- 5 Lower Lounge
- 6 Main Lounge
- 7 Elevator
- 8 Zen Wellness Studio
- 9 Massage Rooms
- 10 Main Restaurant
- 11 Reception
- 12 Water Sports Platform
- 13 Jimmy's Restaurant
- 14 The Chef's Table Restaurant



Note: Elevator reaches the Violin, Cello and Piano Deck; pop-up lift available for Sun Deck access.

.....●.....  
Staterooms can become adjoining by request.

▲  
Up to triple and quad occupancy

### Stateroom Categories

