

EXCLUSIVE 14-DAY RHÔNE RIVER WINE CRUISE!

AMACELLO MAY 4-18, 2023

As a segment of the Grand France Wine Cruise, space is limited for individual segments.



Suite, Violin Deck
French Balcony, 255 sq. ft.

Note: Stateroom layouts shown below are not to scale.



Brochure Fare: \$15,596 pp



CAT. A+, Violin Deck
French Balcony, 225 sq. ft.

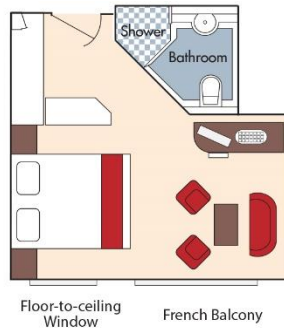

Brochure Fare: \$15,296 pp



CAT. A, Violin Deck
French Balcony, 170 sq. ft.

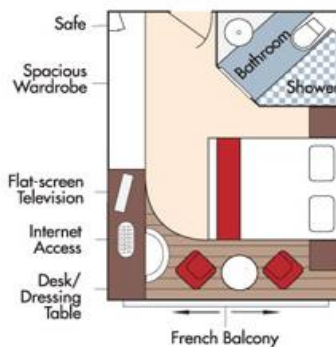

Brochure Fare: \$12,996 pp

Fares listed are cruise-only, per person based on double occupancy and do not include port charges of \$420 per person. Stateroom photos above show typical décor for each stateroom category; actual décor may vary.

CAT. B, Violin & Cello Deck
French Balcony, 170 sq. ft.

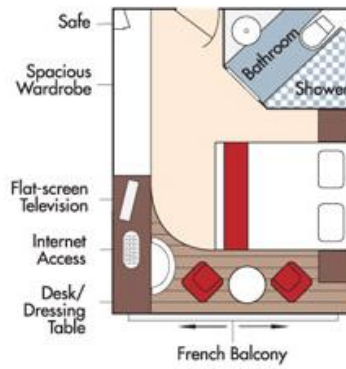

Brochure Fare: \$12,796 pp

CAT. C, Violin & Cello Deck
French Balcony, 170 sq. ft.

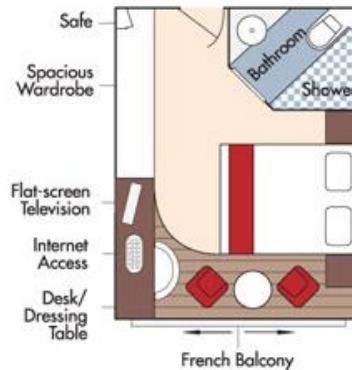

Brochure Fare: \$12,196 pp

CAT. E, Piano Deck
Fixed Windows, 170 sq. ft.

CAT. D, Piano Deck
Fixed Windows, 170 sq. ft.

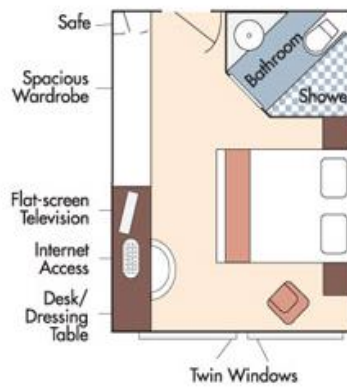

Category D
Brochure Fare: \$10,096 pp

Category E
Brochure Fare: \$9,498 pp

AmaCello Deck Plan

Sun Deck



Violin Deck



Cello Deck



Piano Deck



Stateroom Categories



Fares listed are cruise-only, per person based on double occupancy and do not include port charges of \$420 per person. Stateroom photos above show typical décor for each stateroom category; actual décor may vary.