

# Boisset Collection Wine Cruise

Aboard AmaKristina • 7 Nights • May 9-16, 2024  
Lyon to Arles

*Note: Stateroom layouts shown below are not to scale.*



## Suite *Violin Deck*

French Balcony & Outside Balcony, 350 sq. ft. **Wine Cruise rate \$9,040 pp**

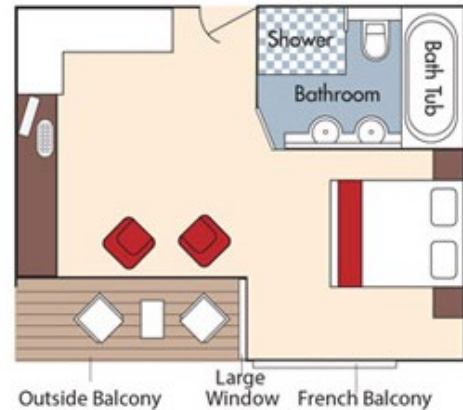

## Category AA *Violin Deck*

French Balcony & Outside Balcony, 235 sq. ft. **Wine Cruise rate \$7,740 pp**

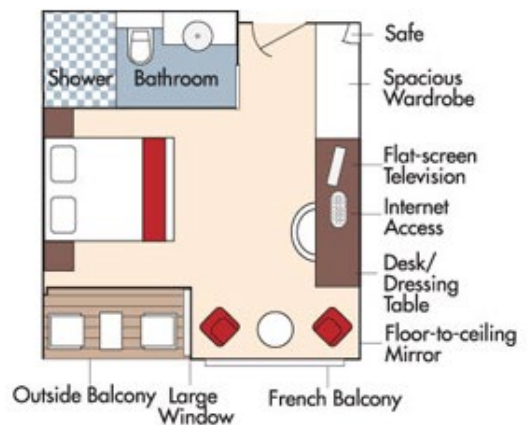

*Fares listed are cruise-only, per person based on double occupancy and include the exclusive wine package. Port charges of \$224 per person are additional.*



### Category AB *Cello Deck*

French Balcony & Outside Balcony, 235 sq. ft. **Wine Cruise rate \$7,540 pp**

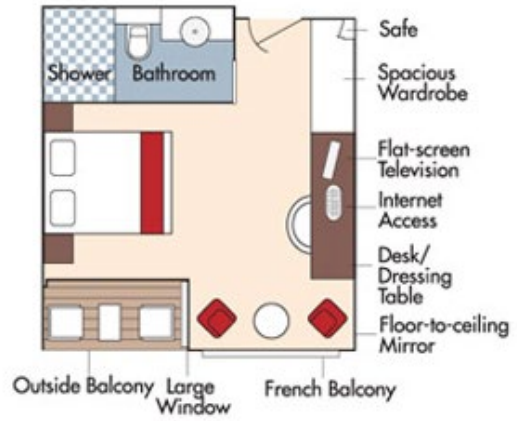

### Category BA *Violin Deck*

French Balcony & Outside Balcony, 210 sq. ft. **Wine Cruise rate \$7,340 pp**

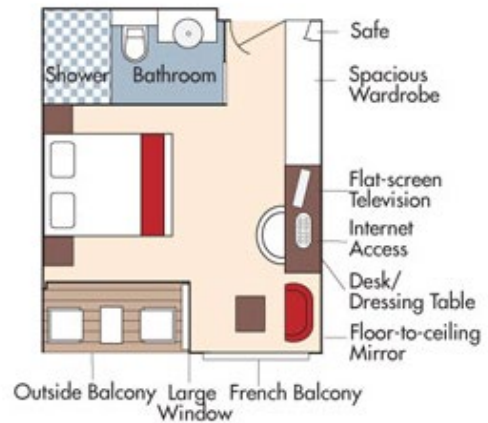

## Category BB *Cello Deck*

French Balcony & Outside Balcony, 210 sq. ft. Wine Cruise rate \$7,140 pp

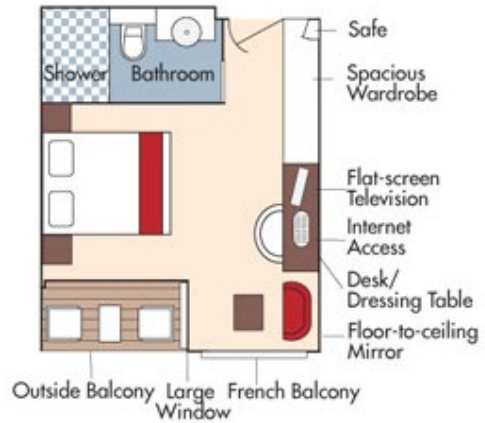

## Category CA *Violin & Cello Deck*

French Balcony, 170 sq. ft.



Category CA  
Wine Cruise rate \$6,540 pp

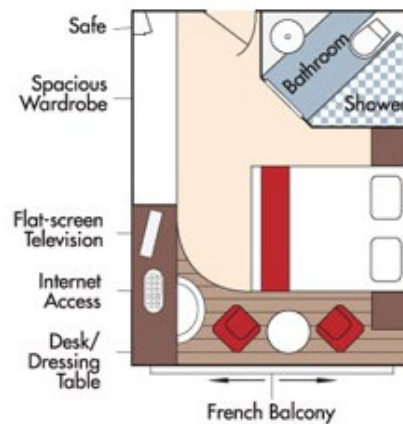

## Category CB *Violin Deck*

French Balcony, 155 sq. ft.



Category CB  
Wine Cruise rate \$6,140 pp

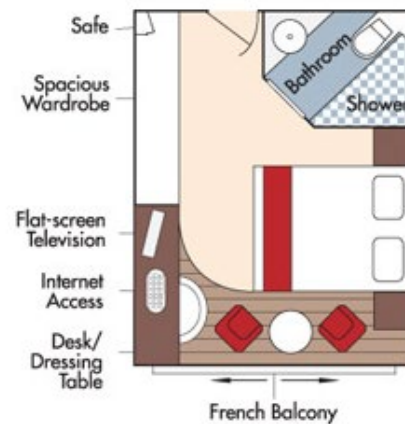

**Category D** *Piano Deck*  
Fixed Windows, 160 sq. ft.



Wine Cruise rate \$5,540 pp

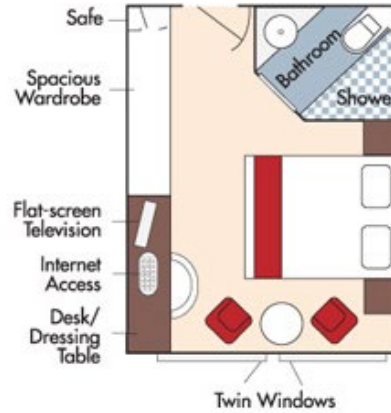

**Category E** *Piano Deck*  
Fixed Windows, 160 sq. ft.

Wine Cruise rate \$5,241 pp

*AmaKristina*  
**DECK PLAN**

- 1 Lower Sun Deck
- 2 Navigation Bridge
- 3 Bicycles
- 4 Heated Pool
- 5 Sun Deck
- 6 Walking Track
- 7 Al Fresco Terrace
- 8 Observation Lounge
- 9 Main Lounge & Bar
- 10 Gift Shop
- 11 Reception
- 12 The Chef's Table Restaurant
- 13 Main Restaurant
- 14 Elevator
- 15 Massage & Hair Salon
- 16 Fitness Room
- 17 Crew Cabins

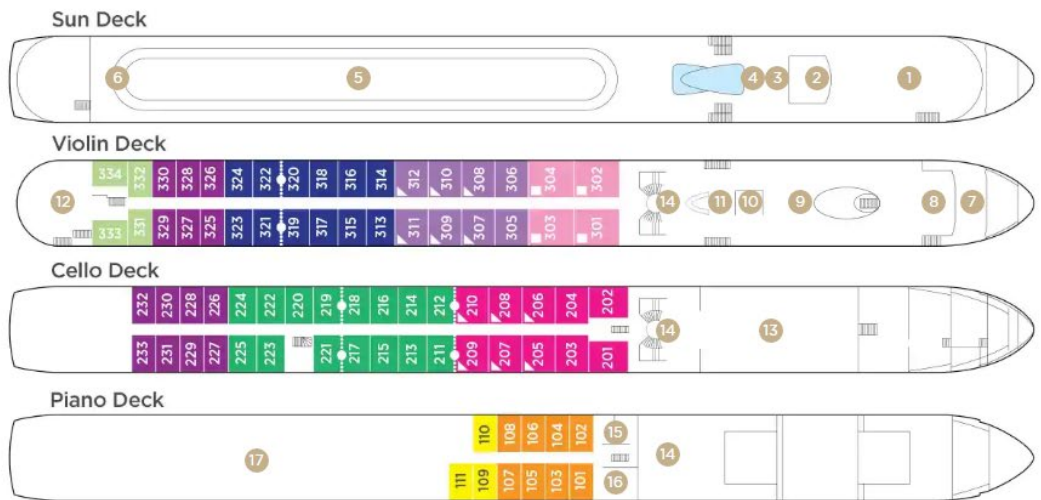

*Note: Elevator reaches the Violin, Cello and Piano Deck (does not reach the Sun Deck).*

Staterooms can become adjoining by request.

Up to triple occupancy

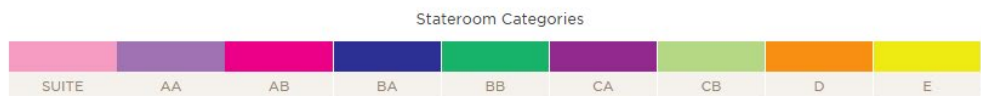

Fares listed are cruise-only, per person based on double occupancy and include the exclusive wine package. Port charges of \$224 per person are additional.