

WINE CRUISE THROUGH SOUTHERN FRANCE WITH COLLIER FALLS WINERY

Aboard AmaKristina • 7 Nights • June 22 to 29, 2023

Lyon • Trevoux • Vienne • Tournon • Avignon • Arles

Note: Stateroom layouts shown below are not to scale.

 **Suite** *Violin Deck*
French Balcony & Outside Balcony, 350 sq. ft.

Wine Cruise Rate \$7,798 pp

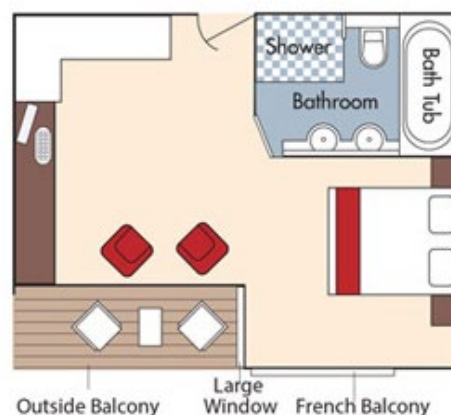

 **Category AA** *Violin Deck*
French Balcony & Outside Balcony, 235 sq. ft.

Wine Cruise Rate \$6,498 pp

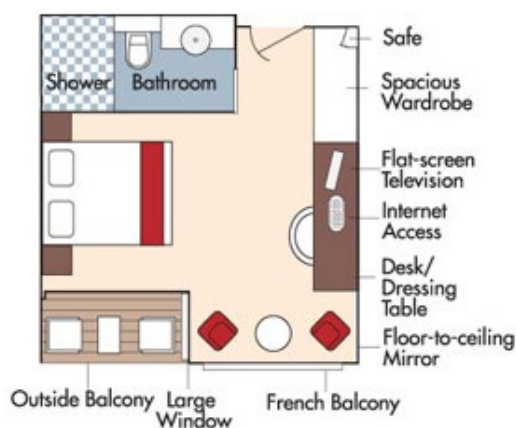

Fares listed are cruise-only, per person based on double occupancy and do not include port charges of \$210 per person.



Category AB *Cello Deck*

French Balcony & Outside Balcony, 235 sq. ft.

Wine Cruise Rate \$6,298 pp

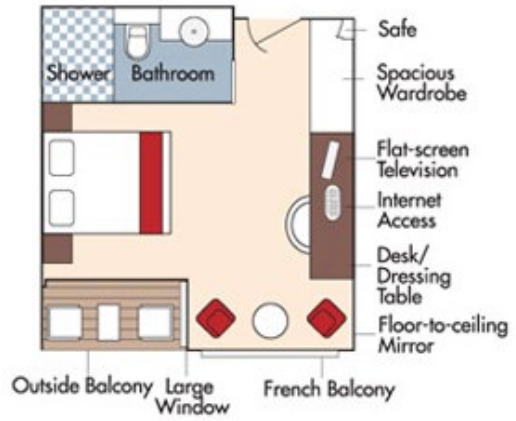

Category BA *Violin Deck*

French Balcony & Outside Balcony, 210 sq. ft.

Wine Cruise Rate \$6,098 pp

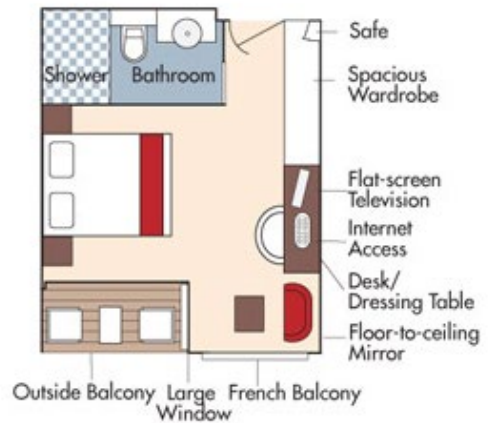



Category BB *Cello Deck*

French Balcony & Outside Balcony, 210 sq. ft.

Wine Cruise Rate \$5,898 pp

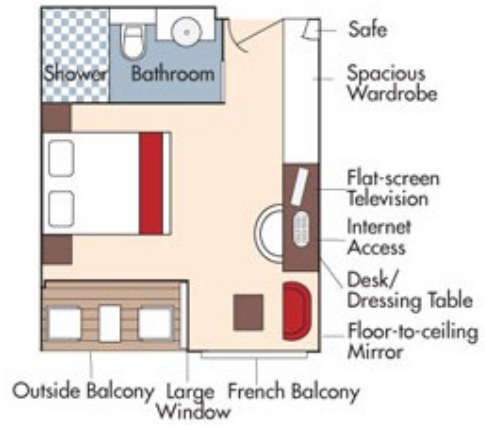

Category CA *Violin & Cello Deck*

French Balcony, 170 sq. ft.

Category CA

Wine Cruise Rate \$5,298 pp

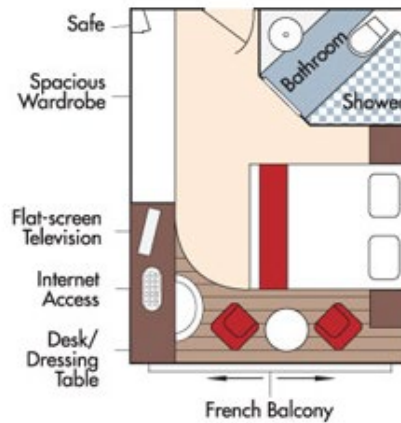

Category CB *Violin Deck*

French Balcony, 155 sq. ft.

Category CB

Wine Cruise Rate \$4,998 pp

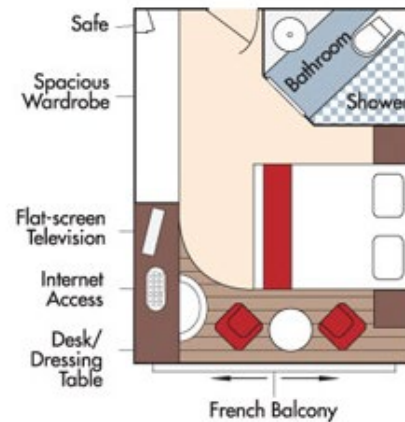

Fares listed are cruise-only, per person based on double occupancy and do not include port charges of \$210 per person.

Category D *Piano Deck*
Fixed Windows, 160 sq. ft.

Wine Cruise Rate \$4,498 pp

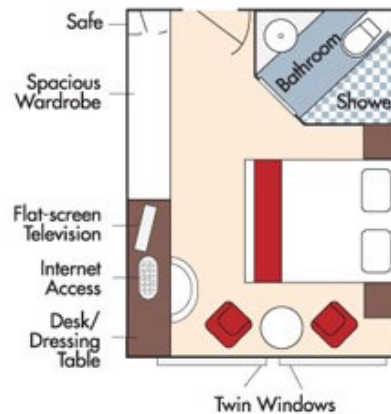

Category E *Piano Deck*
Fixed Windows, 160 sq. ft.

Wine Cruise Rate \$4,199 pp

AmaKristina DECK PLAN

1	Lower Sun Deck
2	Navigation Bridge
3	Bicycles
4	Heated Pool
5	Sun Deck
6	Walking Track
7	Al Fresco Terrace
8	Observation Lounge
9	Main Lounge & Bar
10	Gift Shop
11	Reception
12	The Chef's Table Restaurant
13	Main Restaurant
14	Elevator
15	Massage & Hair Salon
16	Fitness Room
17	Crew Cabins

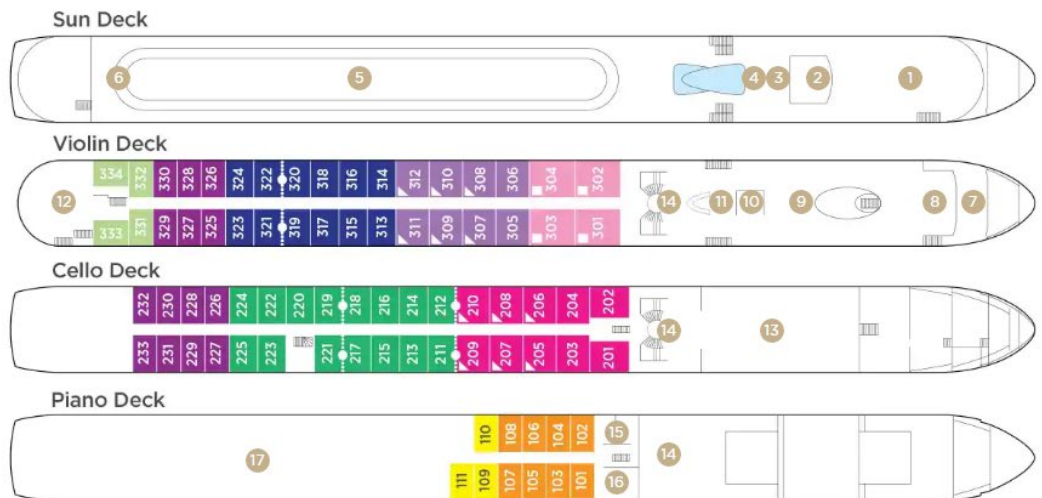

Note: Elevator reaches the Violin, Cello and Piano Deck (does not reach the Sun Deck).

Staterooms can become adjoining by request.

Up to triple occupancy

Stateroom Categories



Fares listed are cruise-only, per person based on double occupancy and do not include port charges of \$210 per person.