



Special Rates when you book by March 31, 2022

# RIVER CRUISE FOR WINE LOVERS

## Oak Knoll District Wine Cruise • April 7 – 14, 2022

Bordeaux • Libourne • Saint-Émilion • Blaye • Bourg • Pauillac • Cadillac

### AmaDolce

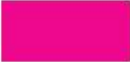

Suite, Violin Deck  
French Balcony, 255 sq. ft.

Note: Stateroom layouts shown below are not to scale.



Brochure Fare: ~~\$6,589~~ pp  
Your Rate: \$6,339 pp



CAT. A+, Violin Deck  
French Balcony, 225 sq. ft.

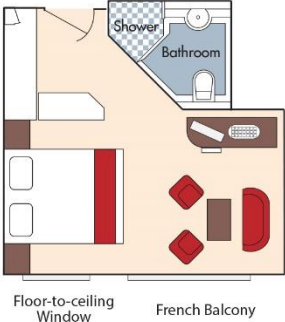

Brochure Fare: ~~\$6,298~~ pp  
Your Rate: \$6,048 pp



CAT. A, Violin Deck  
French Balcony, 170 sq. ft.

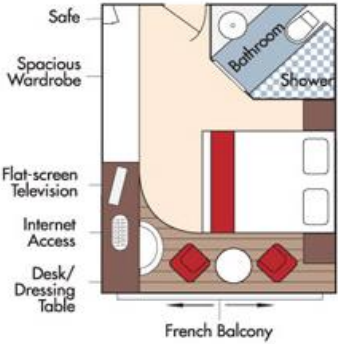

Brochure Fare: ~~\$5,298~~ pp  
Your Rate: \$5,048 pp

Fares listed are cruise-only, per person based on double occupancy and do not include port charges of \$210 per person.

**CAT. B, Violin & Cello Deck**  
French Balcony, 170 sq. ft.

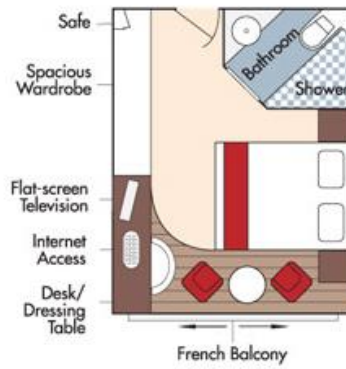

Brochure Fare: ~~\$5,198~~ pp  
Your Rate: **\$4,948 pp**

**CAT. C, Violin & Cello Deck**  
French Balcony, 170 sq. ft.

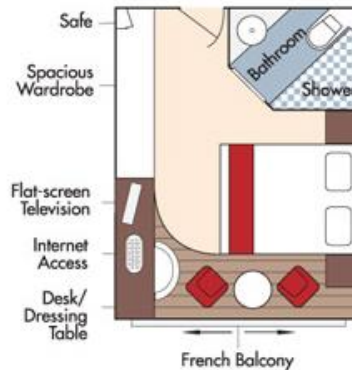

Brochure Fare: ~~\$4,898~~ pp  
Your Rate: **\$4,648 pp**

**CAT. E, Piano Deck**  
Fixed Windows, 170 sq. ft.



**CAT. D, Piano Deck**  
Fixed Windows, 170 sq. ft.

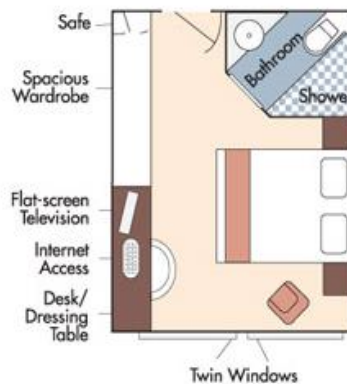

Category D  
Brochure Fare: ~~\$4,098~~ pp  
Your Rate: **\$3,848 pp**

Category E  
Brochure Fare: ~~\$3,799~~ pp  
Your Rate: **\$3,549 pp**

## AmaDolce Deck Plan

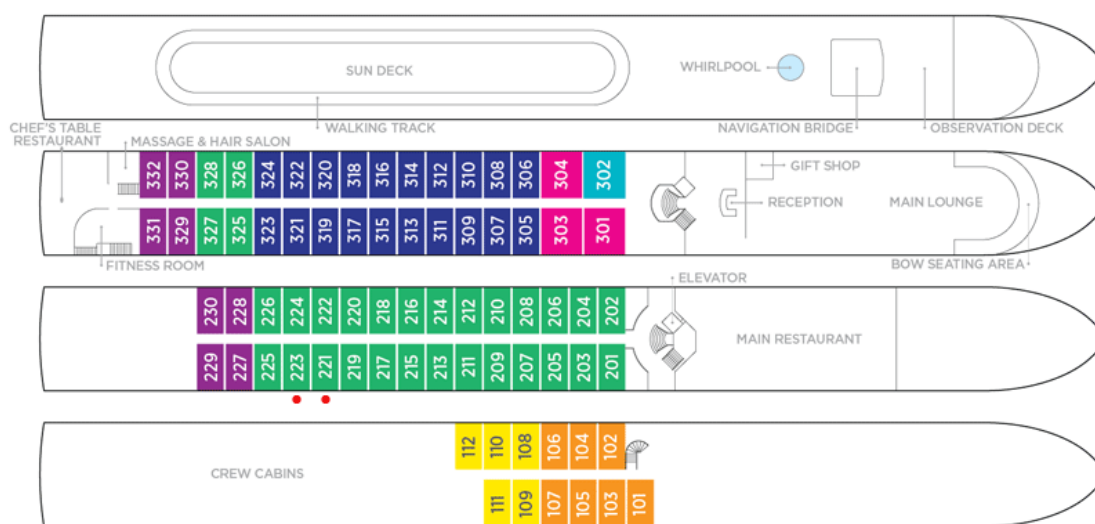

Fares listed are cruise-only, per person based on double occupancy and do not include port charges of \$210 per person.