



RIVER CRUISE FOR WINE LOVERS

Ron Noble Wines

Aboard AmaSiena • 7 Nights • March 31 to April 7, 2022

Amsterdam • Cologne • Rudesheim • Ludwigshafen • Heidelberg • Strasbourg • Riquewihr • Breisach • Basel

Note: Stateroom layouts shown below are not to scale.



Suite *Violin Deck*

French Balcony & Outside Balcony, 350 sq. ft.

Brochure Fare \$6,698 pp

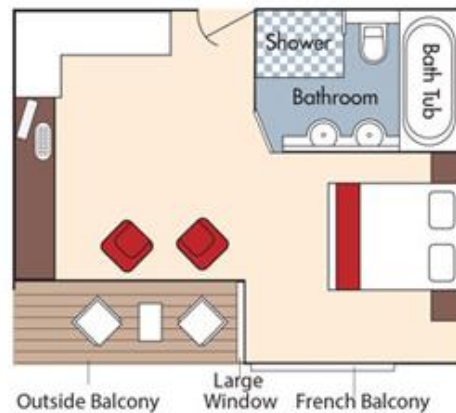

Category AA *Violin Deck*

French Balcony & Outside Balcony, 235 sq. ft.

Brochure Fare \$5,398 pp

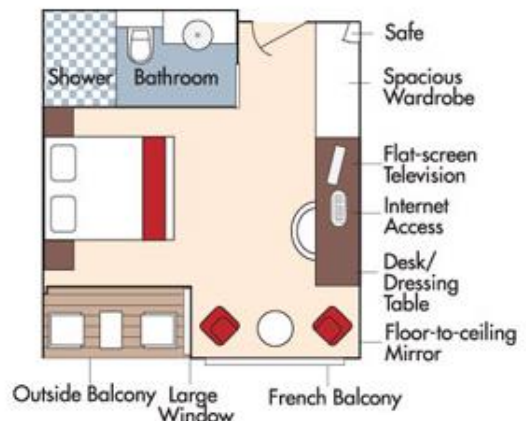

Fares listed are cruise-only, per person based on double occupancy and do not include port charges of \$210 per person.



Category AB *Cello Deck*

French Balcony & Outside Balcony, 235 sq. ft.

Brochure Fare \$5,198 pp

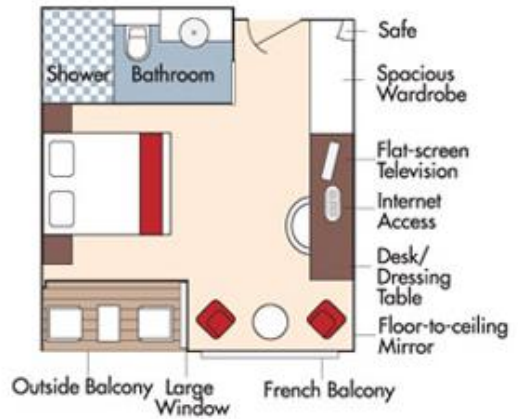

Category BA *Violin Deck*

French Balcony & Outside Balcony, 210 sq. ft.

Brochure Fare \$4,998 pp

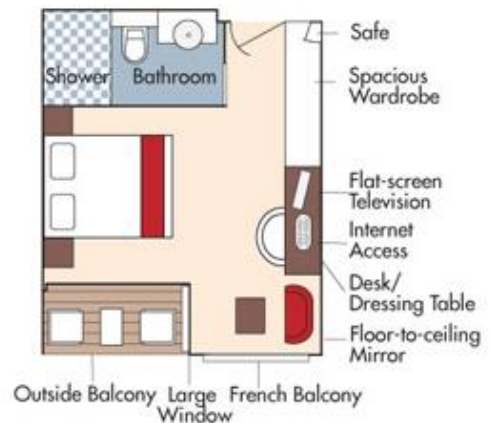



Category BB *Cello Deck*

French Balcony & Outside Balcony, 210 sq. ft.

Brochure Fare \$4,798 pp

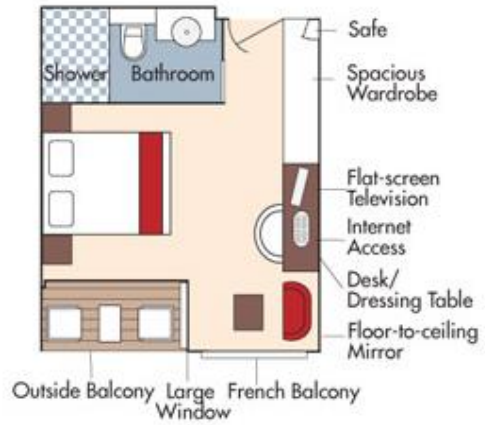

Category CA *Violin & Cello Deck*

French Balcony, 170 sq. ft.

Category CA

Brochure Fare \$4,198 pp

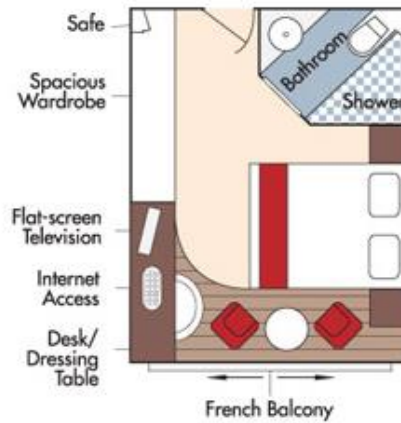

Category CB *Violin Deck*

French Balcony, 155 sq. ft.

Category CB

Brochure Fare \$3,898 pp

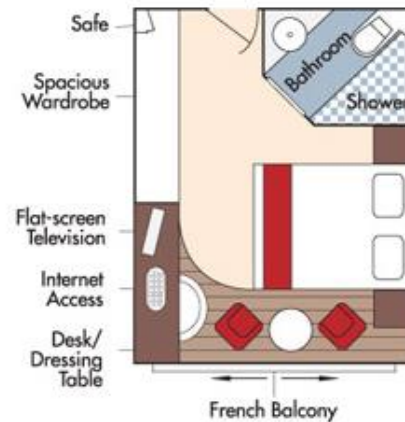

Fares listed are cruise-only, per person based on double occupancy and do not include port charges of \$210 per person.

Category D *Piano Deck*
Fixed Windows, 160 sq. ft.

Brochure Fare \$3,398 pp

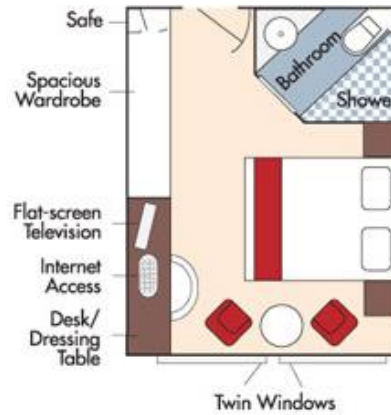

Category E *Piano Deck*
Fixed Windows, 160 sq. ft.

Brochure Fare \$3,099 pp

AmaSiena DECK PLAN

1	Lower Sun Deck
2	Navigation Bridge
3	Bicycles
4	Heated Pool
5	Sun Deck
6	Walking Track
7	AI Fresco Terrace
8	Observation Lounge
9	Main Lounge & Bar
10	Gift Shop
11	Reception
12	The Chef's Table Restaurant
13	Main Restaurant
14	Elevator
15	Massage & Hair Salon
16	Fitness Room
17	Crew Cabins

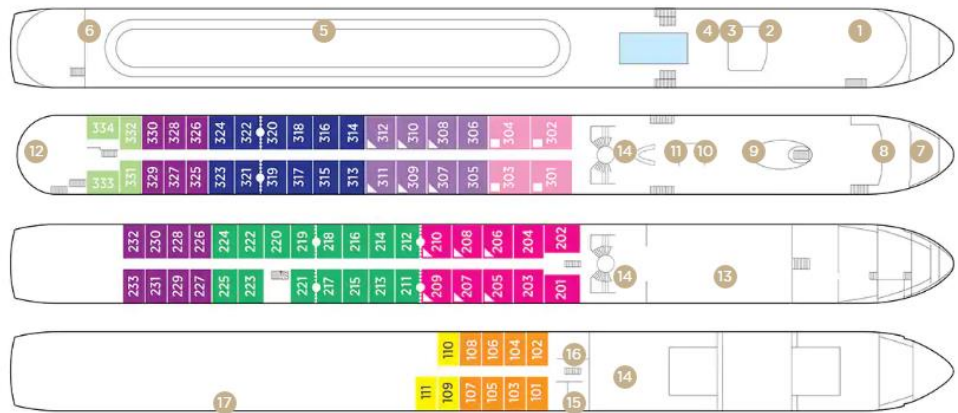

Note: Elevator reaches the Violin, Cello and Piano Deck (does not reach the Sun Deck).

..... Staterooms can become adjoining by request.

▲ Up to triple occupancy

Stateroom Categories



Fares listed are cruise-only, per person based on double occupancy and do not include port charges of \$210 per person.