



# RIVER CRUISE FOR WINE LOVERS

## Peterson Winery

Aboard AmaSiena • 7 Nights • April 7 to 14, 2022

Basel • Breisach • Strasbourg • Ludwigshafen • Rüdesheim • Lahnstein • Cologne • Amsterdam

*Note: Stateroom layouts shown below are not to scale.*



### Suite *Violin Deck*

French Balcony & Outside Balcony, 350 sq. ft.

Brochure Fare \$6,798 pp

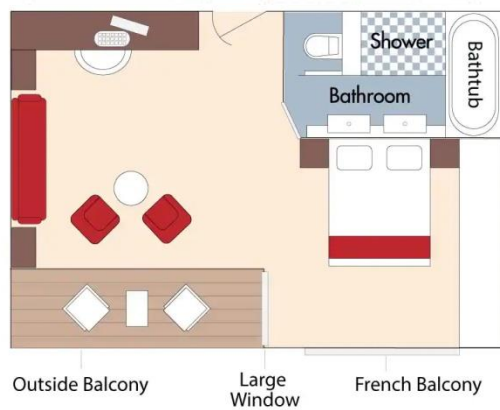

### Category AA *Violin Deck*

French Balcony & Outside Balcony, 235 sq. ft.

Brochure Fare \$5,498 pp

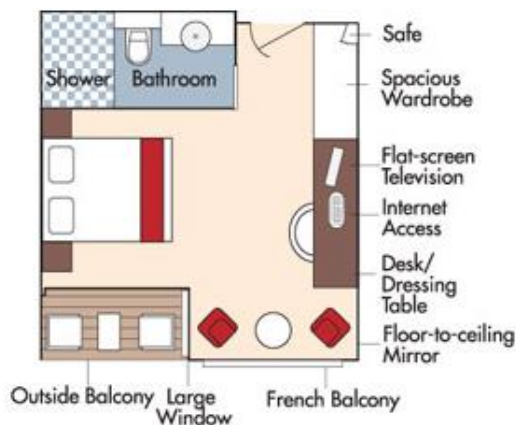

*Fares listed are cruise-only, per person based on double occupancy and do not include port charges of \$210 per person.*



## Category AB *Cello Deck*

French Balcony & Outside Balcony, 235 sq. ft.

Brochure Fare \$5,298 pp

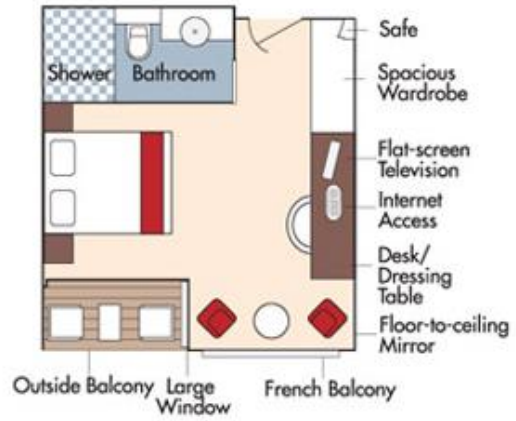

## Category BA *Violin Deck*

French Balcony & Outside Balcony, 210 sq. ft.

Brochure Fare \$5,098 pp

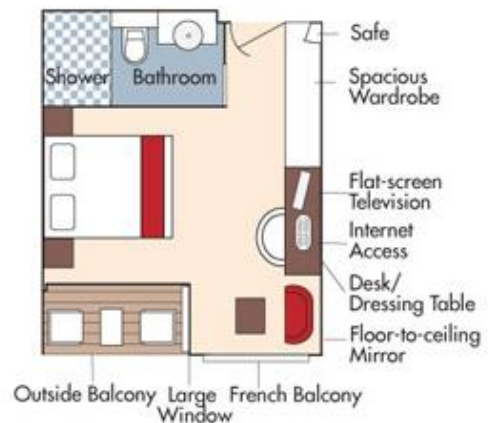



**Category BB** *Cello Deck*  
French Balcony & Outside Balcony, 210 sq. ft.

Brochure Fare \$4,898 pp

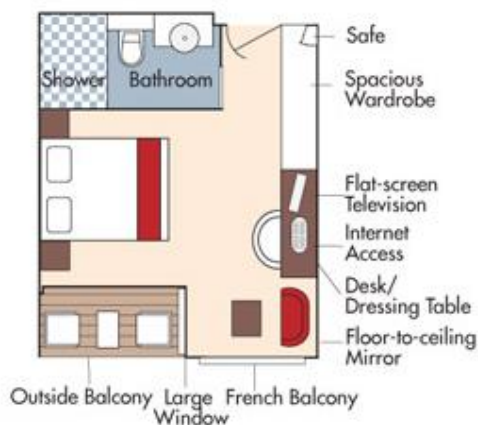

**Category CA** *Violin & Cello Deck*  
French Balcony, 170 sq. ft.

Category CA  
Brochure Fare \$4,298 pp

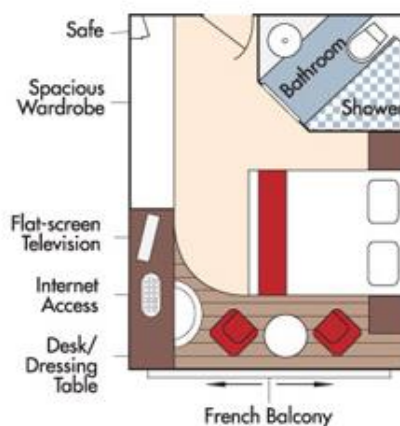

**Category CB** *Violin Deck*  
French Balcony, 155 sq. ft.

Category CB  
Brochure Fare \$3,998 pp

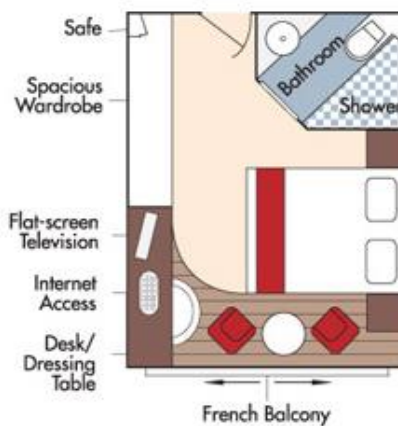

Fares listed are cruise-only, per person based on double occupancy and do not include port charges of \$210 per person.



## Category D *Piano Deck*

Fixed Windows, 160 sq. ft.

Brochure Fare \$3,498 pp

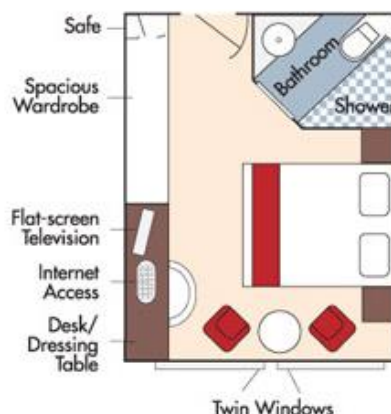

## Category E *Piano Deck*

Fixed Windows, 160 sq. ft.

Brochure Fare \$3,199 pp

## AmaSiena DECK PLAN

1	Lower Sun Deck
2	Navigation Bridge
3	Bicycles
4	Heated Pool
5	Sun Deck
6	Walking Track
7	Al Fresco Terrace
8	Observation Lounge
9	Main Lounge & Bar
10	Gift Shop
11	Reception
12	The Chef's Table Restaurant
13	Main Restaurant
14	Elevator
15	Massage & Hair Salon
16	Fitness Room
17	Crew Cabins



Note: Elevator reaches the Violin, Cello and Piano Deck (does not reach the Sun Deck).

..... Staterooms can become adjoining by request.

▲ Up to triple occupancy

### Stateroom Categories

SUITE	AA	AB	BA	BB	CA	CB	D	E
-------	----	----	----	----	----	----	---	---

Fares listed are cruise-only, per person based on double occupancy and do not include port charges of \$210 per person.