

The Rotary Foundation 2022 Cruise Through Southern France

Aboard AmaKristina • 7 Nights • April 28, 2022

Lyon • Collonges • Vienne • Tournon • Tarascon • Avignon

Note: Stateroom layouts shown below are not to scale.

Suite *Violin Deck*
French Balcony & Outside Balcony, 350 sq. ft.



Brochure Rate: \$7,698 pp

Your rate \$7,448 pp

when you book by 4/30/21

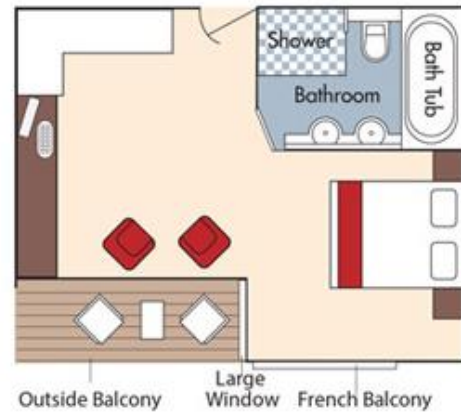

Category AA *Violin Deck*
French Balcony & Outside Balcony, 235 sq. ft.



Brochure Rate: \$6,398 pp

Your rate \$6,148 pp

when you book by 4/30/21

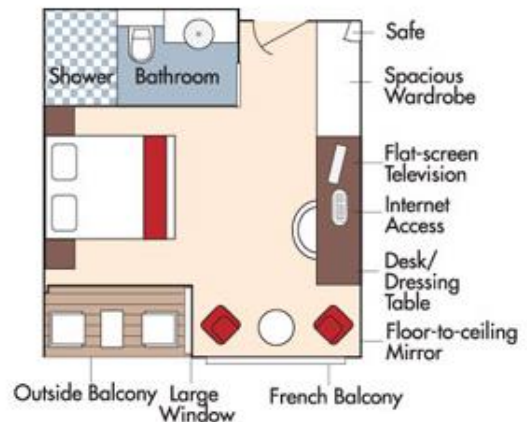

Fares listed are cruise-only, per person based on double occupancy. Port charges of \$210 per person are additional.



Category AB *Cello Deck*

French Balcony & Outside Balcony, 235 sq. ft.

Brochure Rate: \$6,198 pp

Your rate \$5,948 pp
when you book by 4/30/21

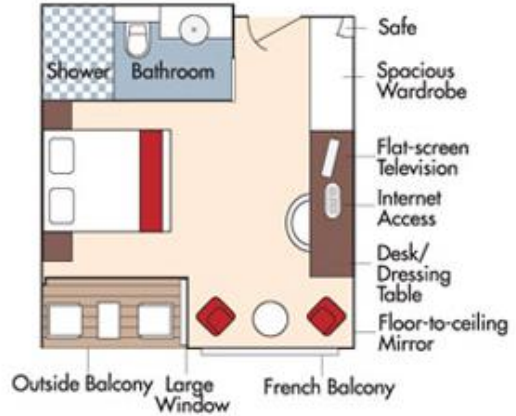

Category BA *Violin Deck*

French Balcony & Outside Balcony, 210 sq. ft.

Brochure Rate: \$5,998 pp

Your rate \$5,748 pp
when you book by 4/30/21

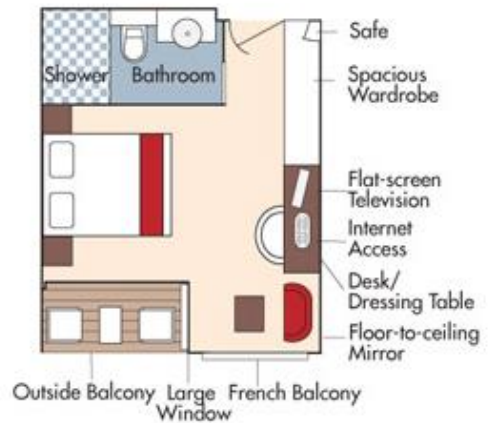



Category BB *Cello Deck*

French Balcony & Outside Balcony, 210 sq. ft.

Brochure Rate: \$5,798 pp

Your rate \$5,548 pp
when you book by 4/30/21

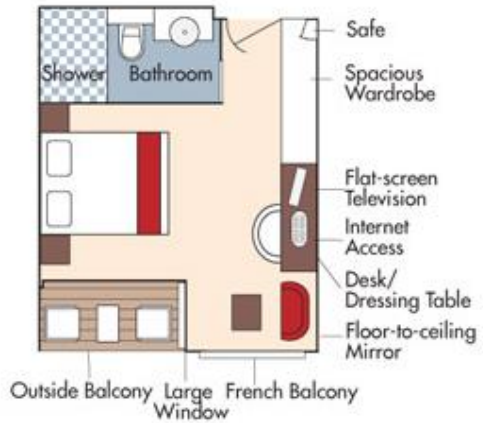

Category CA *Violin & Cello Deck*

French Balcony, 170 sq. ft.

Brochure Rate: \$5,198 pp

Your rate \$4,948 pp
when you book by 4/30/21

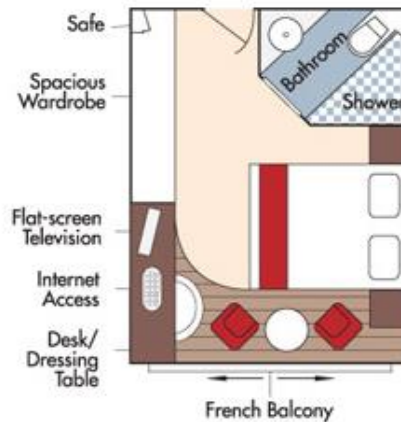

Category CB *Violin Deck*

French Balcony, 155 sq. ft.

Brochure Rate: \$4,898 pp

Your rate \$4,648 pp
when you book by 4/30/21

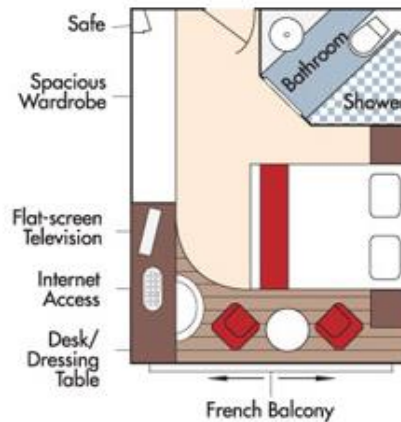

Fares listed are cruise-only, per person based on double occupancy. Port charges of \$210 per person are additional.

Category D *Piano Deck*
Fixed Windows, 160 sq. ft.

Brochure Rate: \$4,398 pp
Your rate \$4,148 pp
when you book by 4/30/21

Category E *Piano Deck*
Fixed Windows, 160 sq. ft.

Brochure Rate: \$4,099 pp
Your rate \$3,849 pp
when you book by 4/30/21

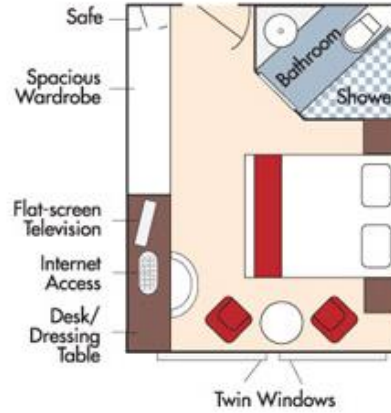

AmaKristina DECK PLAN

[ENLARGE DECK PLAN](#)

- 1 Lower Sun Deck
- 2 Navigation Bridge
- 3 Bicycles
- 4 Heated Pool
- 5 Sun Deck
- 6 Walking Track
- 7 Al Fresco Terrace
- 8 Observation Lounge
- 9 Main Lounge & Bar
- 10 Gift Shop
- 11 Reception
- 12 The Chef's Table Restaurant
- 13 Main Restaurant
- 14 Elevator
- 15 Massage & Hair Salon
- 16 Fitness Room
- 17 Crew Cabins

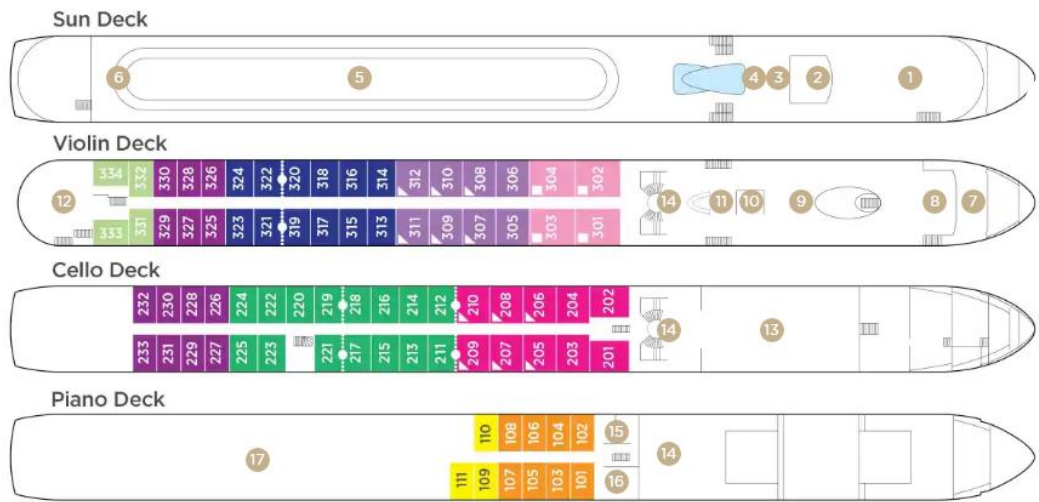

Note: Elevator reaches the Violin, Cello and Piano Deck (does not reach the Sun Deck).

Staterooms can become adjoining by request.

Up to triple occupancy

Stateroom Categories



Fares listed are cruise-only, per person based on double occupancy. Port charges of \$210 per person are additional.