



# RIVER CRUISE FOR WINE LOVERS

## Montemar Winery

Aboard the AmaDouro • 7 Nights • July 3 to 10, 2021

Porto • Régua • Barca d'Alva • Vega de Terrón • Pinhão • Entre-os-Rios • Porto

Note: Stateroom layouts shown below are not to scale.

### Suite Porto Deck Balcony, 323 sq. ft.

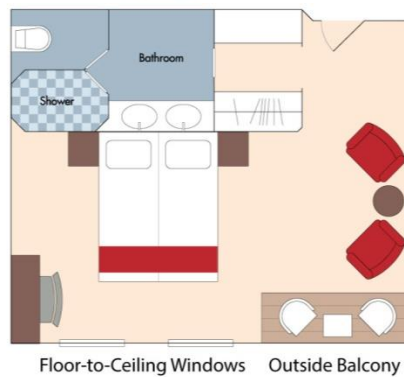

Your Rate: \$7,598 pp  
includes exclusive wine package

### Category A Porto Deck Balcony, 215 sq. ft.

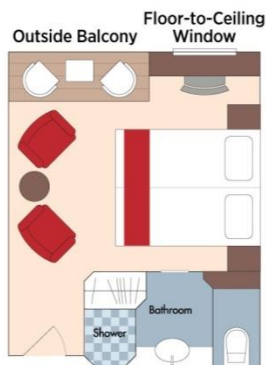

Your Rate: \$5,898 pp  
includes exclusive wine package

### Category B Lisbon Deck Balcony, 215 sq. ft.

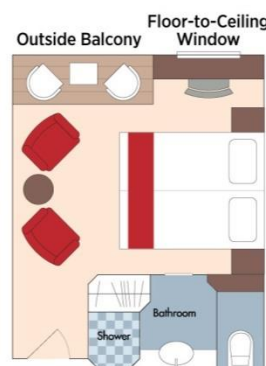

Your Rate: \$5,598 pp  
includes exclusive wine package



## Category C *Porto Deck* French Balcony, 161 sq. ft.

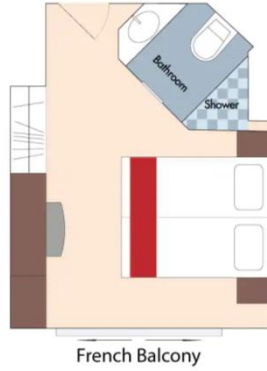

Your Rate: \$4,998 pp

French Balcony



## Category D *Douro Deck* Panoramic Window, 161 sq. ft.



## Category E *Douro Deck* Panoramic Window, 161 sq. ft.

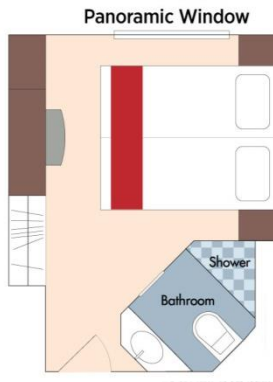

### Category D

Your Rate: \$4,298 pp  
*includes exclusive wine package*

### Category E

Your Rate: \$3,999 pp  
*includes exclusive wine package*

## AmaDouro DECK PLAN

|   |                 |
|---|-----------------|
| 1 | Main Lounge     |
| 2 | Reception       |
| 3 | Elevator        |
| 4 | Main Restaurant |
| 5 | Fitness Room    |
| 6 | Spa             |

### Sun Deck



### Porto Deck

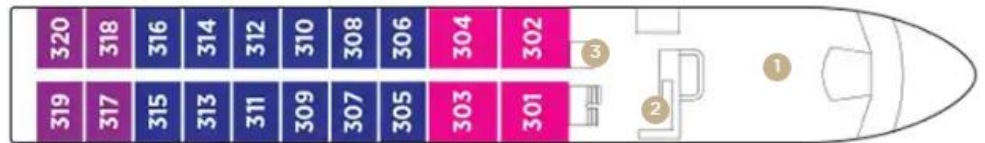

### Lisbon Deck



### Douro Deck



Stateroom Categories

