



**Special Rates when you book
by September 30, 2020**

RIVER CRUISE FOR WINE LOVERS

Gary Farrell Vineyards

Aboard the AmaViola • 7 Nights • March 29 to April 5, 2021

Vilshofen • Passau • Linz • Weissenkirchen • Krems • Vienna • Budapest

Note: Stateroom layouts shown below are not to scale.



Suite, Violin Deck
French Balcony & Outside Balcony, 350 sq. ft.

Brochure Fare ~~\$6,598~~ pp
Your rate \$6,098 pp

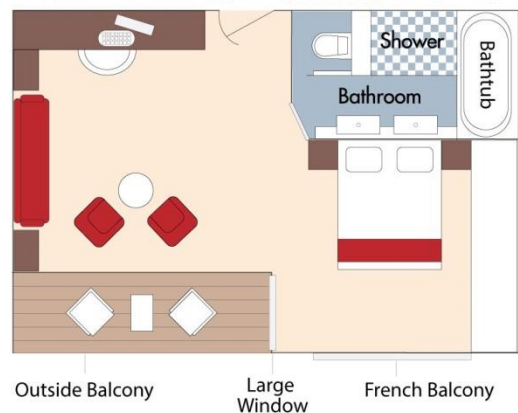

CAT. AA, Violin Deck
French Balcony & Outside Balcony, 235 sq. ft.

Brochure Fare ~~\$5,198~~ pp
Your rate \$4,698 pp

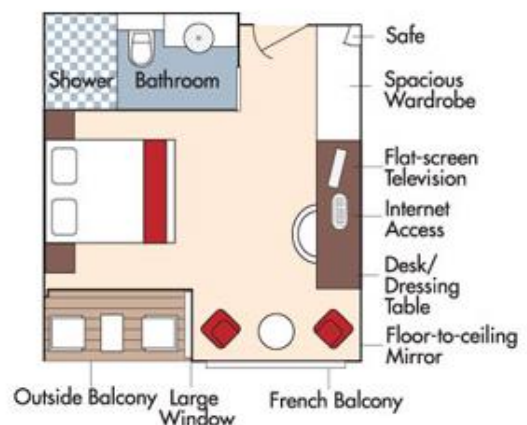

Fares listed are cruise-only, per person based on double occupancy and do not include port charges of \$196 per person.



CAT. AB, Cello Deck
French Balcony & Outside Balcony, 235 sq. ft.

Brochure Fare \$4,998 pp
Your rate \$4,498 pp

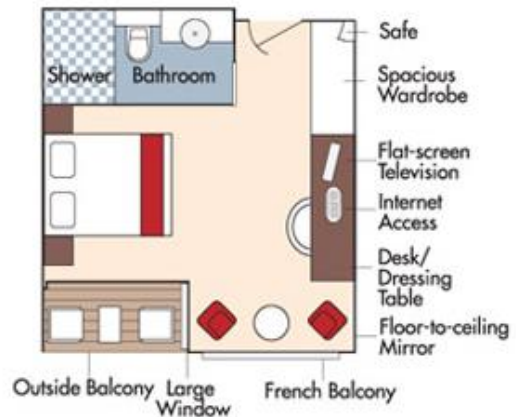

CAT. BA, Violin Deck
French Balcony & Outside Balcony, 210 sq. ft.

Brochure Fare \$4,798 pp
Your rate \$4,298 pp

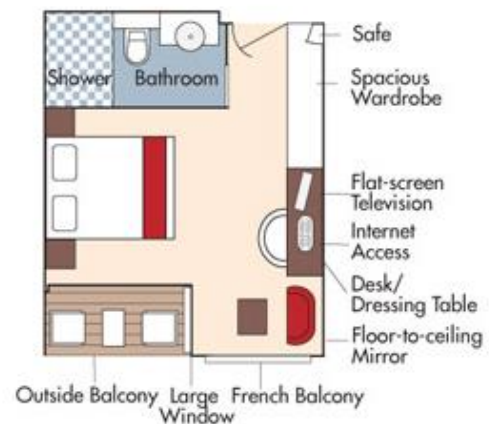



CAT. BB, Cello Deck
French Balcony & Outside Balcony, 210 sq. ft.



Brochure Fare ~~\$4,598~~ pp
Your rate **\$4,098** pp

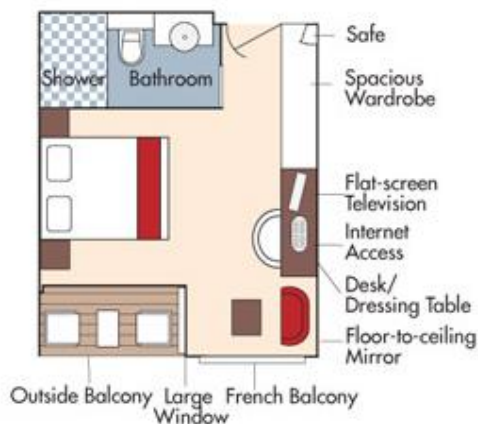

CAT. C, Violin & Cello Deck
French Balcony, 170 sq. ft.



Category CA
Brochure Fare ~~\$3,998~~ pp
Your rate **\$3,498** pp

Category CB
Brochure Fare ~~\$3,698~~ pp
Your rate **\$3,198** pp

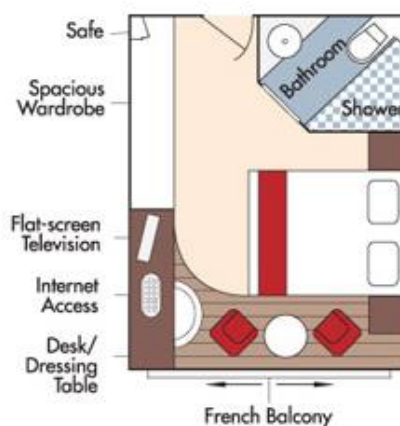



CAT. D, Piano Deck
Fixed Windows, 160 sq. ft.

Brochure Fare \$3,298 pp
Your rate \$2,798 pp

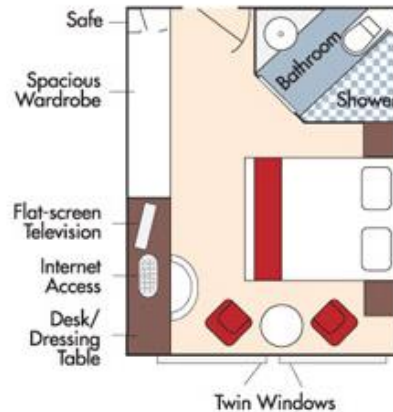

CAT. E, Piano Deck
Fixed Windows, 160 sq. ft.

Brochure Fare \$2,999 pp
Your rate \$2,499 pp

AmaViola Deck Plan

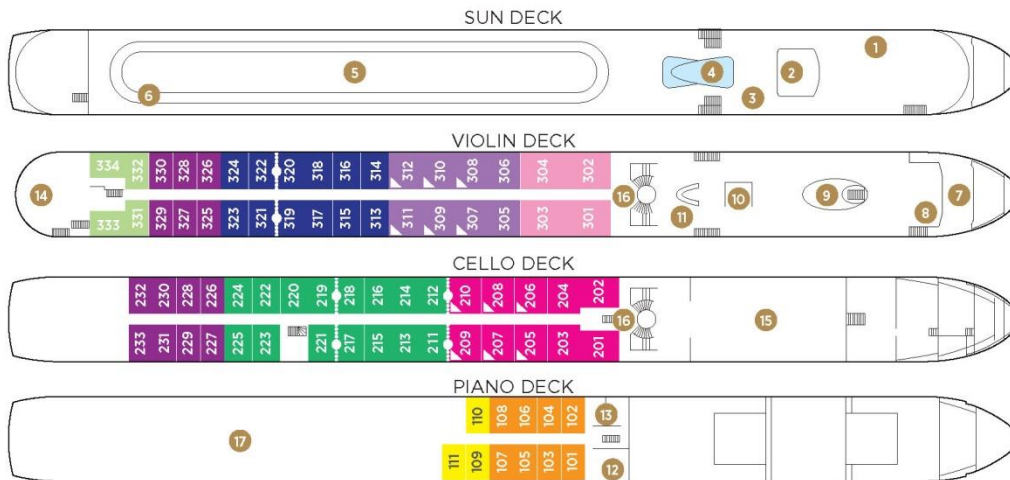

- 1 Lower Sun Deck
- 2 Navigation Bridge
- 3 Bicycles
- 4 Heated Pool
- 5 Sun Deck
- 6 Walking Track
- 7 Al Fresco Dining Terrace
- 8 Observation Lounge
- 9 Main Lounge & Bar
- 10 Gift Shop
- 11 Reception
- 12 Fitness Room
- 13 Massage & Hair Salon
- 14 The Chef's Table Restaurant
- 15 Main Restaurant
- 16 Elevator
- 17 Crew Cabins

Elevator on AmaLea and AmaKristina reaches Main Restaurant, Lobby/Main Lounge and staterooms on Violin, Cello and Piano Deck.
Elevator on AmaStella and AmaViola reaches Main Restaurant, Lobby/Main Lounge and staterooms on Violin and Cello Deck.

Suite	Violin Deck / French & Outside Balcony - 350 sq. ft.	Cat. CA	Violin & Cello Deck / French Balcony - 170 sq. ft.
Cat. AA	Violin Deck / French & Outside Balcony - 235 sq. ft.	Cat. CB	Violin Deck / French Balcony - 155 sq. ft.
Cat. AB	Cello Deck / French & Outside Balcony - 235 sq. ft.	Cat. D	Piano Deck / Fixed Windows - 160 sq. ft.
Cat. BA	Violin Deck / French & Outside Balcony - 210 sq. ft.	Cat. E	Piano Deck / Fixed Windows - 160 sq. ft.
Cat. BB	Cello Deck / French & Outside Balcony - 210 sq. ft.		

..... Staterooms can become adjoining by request.

▲ Up to triple occupancy.

Fares listed are cruise-only, per person based on double occupancy and do not include port charges of \$196 per person.